

Installation Guide – BZ40H/TM – BZ30J/TM – BZ35J/TM-BZ – BZ30|35|40|50L/TM

Description

This procedure should be used with Manage for TEOS Server **from version 3.0** to push configuration like **Signage, Meeting Display, Wayfinding** etc.

This procedure is used for all the **preconfigured “/TM” (for Manage for TEOS) BRAVIA**

New BRAVIA L series portfolio is available for TEOS usage

Requirements

- A set of USB keys formatted in **FAT32** (one per BRAVIA, to parallelize process)
- A USB key formatted in **FAT32** with on the **root** folder *.apk files:
 1. **Connect for TEOS Receiver (please refer to the release note to find the latest apps available)**
 2. **Signage for TEOS App (please refer to the release note to find the latest apps available)**
 3. **Cloud Control for TEOS App (please refer to the release note to find the latest apps available), if your device will be used in the CLOUD**
- For Touch usage on BRAVIA (optional), you can install from pro settings > start up services, both touch assistant and touch keyboard
- Please refer to <https://teos.solutions/> to find all the details, apps, setup if needed (under resources)

Table of Contents

1. Compatible models	4
2. Understanding of the Pro Mode access.....	5
3. Configuration for TEOS Usage.....	6
3.1 Configurations under BRAVIA Settings.	6
3.2 Under settings enable developer options and ADB.	7
3.3 Enable IP Control under settings.....	7
3.4 Installation of apks.	8
3.5 Privacy permissions to TEOS Apps.....	9
3.6 Pro settings configuration.....	11
3.7 Setup the Touch-KeyBoard by default (optional for wayfinding).....	12
3.8 Go to pro settings to allow TEOS Apps & Configure your BRAVIA.....	14
3.9 Finalize the installation by starting pro mode.....	15
4. Add device in TEOS.....	16
4.1 When using TEOS on premise.....	16
4.2 When using TEOS on Cloud (from version 3.0).....	18

1. Compatible models

Make sure the language setup of your device is in English: go to *Settings* and choose **English**. You must be in normal or pro settings mode to be able to do the update. Check in what mode you are. For first installation, the device is in normal mode

Check your version of Android, if you are **already in Android 10**, make sure you are using the **latest available version for all the BRAVIAs**.

Recommended model names are:

- FW-XXBZ30J
- FW-XXBZ35J
- FW-XXBZ40J
- FW-XXBZ30L
- FW-XXBZ35L
- FW-XXBZ40L
- FW-XXBZ50L

The following models may not be Android 10 if already installed but a firmware upgrade can allow them to have the same version as the other models in Android 10:

- FW-XXBZ40H

Please visit our website <https://pro-bravia.sony.net/> to find all details about BRAVIA including firmwares under resources and you BRAVIA model and Firmware Update

SONY

BRAVIA™ Professional Displays Knowledge Center

Home

Guides

Develop

Resources

FAQ

Glossary

Products

Search

▶ BZ30L Series (for China)

▶ BZ40J Series

▶ BU40J Series (for China)

▶ BZ35J Series

▶ BU35J Series (for China)

▼ BZ30J Series

Specifications

HDMI Inputs Spec

Security Information

Wall Mount

Firmware Update

Manuals

CAD Data

▶ Settings (Android 10.0)

▶ BU30J Series (for China)

Firmware update for using a USB storage device

Note: The information may vary depending on the country / region.

Version	Release Date	Download	Release Notes
6.7240 (Android 10.0)	14 Jul 2023	<div>Download</div> <div>(1.5GB)</div>	<ul style="list-style-type: none">The ECO menu has been added. You can check ECO information and change ECO settings from Quick Settings or Settings.BRAVIA Signage Free is now pre-installed.The access points for the pro settings menu has been changed. The menu can now also be opened from the "Pro settings" application.Other functional improvements, specification changes, and bug fixes have been made.
6.6495 (Android 10.0)	20 Apr 2023	<div>Download</div> <div>(1.4GB)</div>	<ul style="list-style-type: none">Fixes a bug that caused a green screen (audio output) in rare cases when the power was turned on.Fixes a bug that the Multi Display Settings window returns to the full screen display when switching contents.Improves some minor issues.

4 | Installation Guide – BRAVIA Android 10 with TEOS Connect and Signage App /TM

SONY

2. Understanding of the Pro Mode access

In [Pro mode], you can use various convenient functions for professional use. Here, we introduce how to change to [Pro mode] and typical functions of [Pro mode].

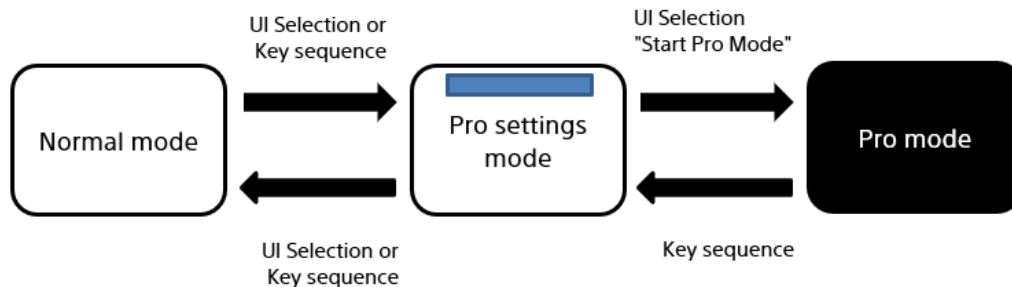

Normal mode: This is the default mode. [Pro mode] functions are not available in this mode.

Pro settings mode: This mode allows you to set various settings of [Pro mode] functions.

Pro mode: This is the professional use where you can use the [Pro mode] functions.

After each switch in each mode, the monitor will reboot.

Key sequence (press the below keys on the remote commander in order within 3 seconds)



UI Selection (only for FW-XXBZ models), this option allows you to switch between the different modes using the Android UI (app view)

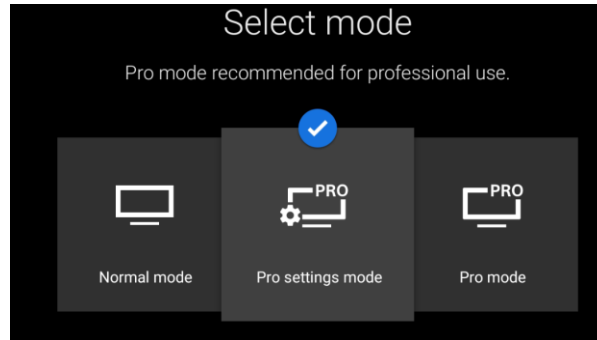

* Initially you cannot change the mode from [Pro mode tool] in [Pro mode]. If you want to change the mode from [Pro mode tool], go to [Pro settings] t [Function restrictions] t [Apps] and change [Pro mode tool] to [Enable] in [Pro settings mode].

3. Configuration for TEOS Usage

To start this procedure, you need to make sure your device is in pro settings and shows pro settings in process. If it is not the case, please refer to the procedure upper.

3.1 Configurations under BRAVIA Settings.

When you are in BRAVIA home menu, go to settings > system

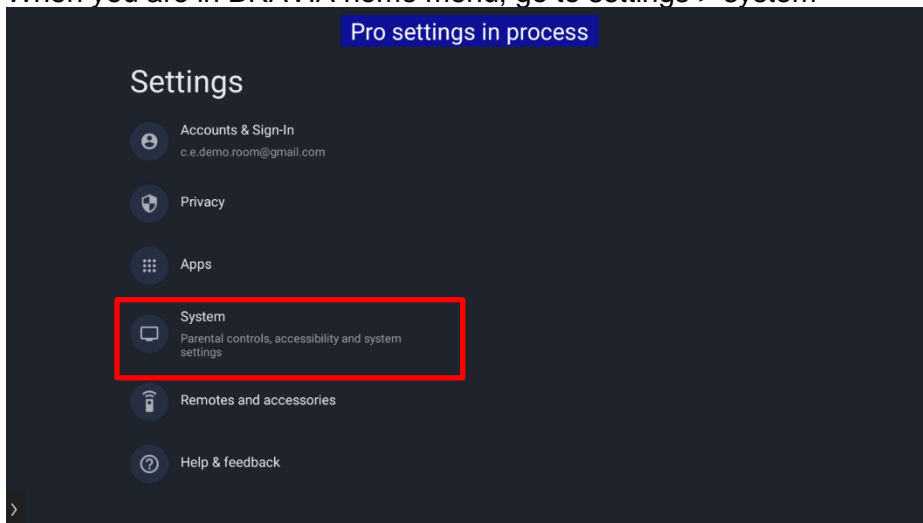

- a) Go to settings > System > Power
 - set power saving, Idle TV standby, Auto shut-off to Off

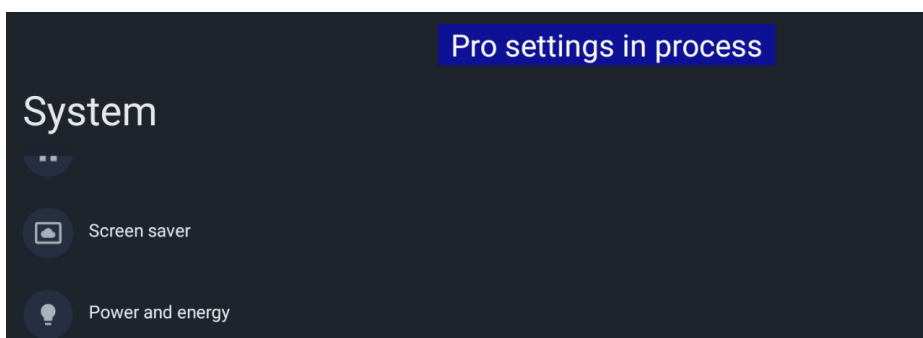

3.2 Under settings enable developer options and ADB.

- a) For that go back to Settings > System > About > Build
 - Press 7 times in build option, developer mode will be unlocked

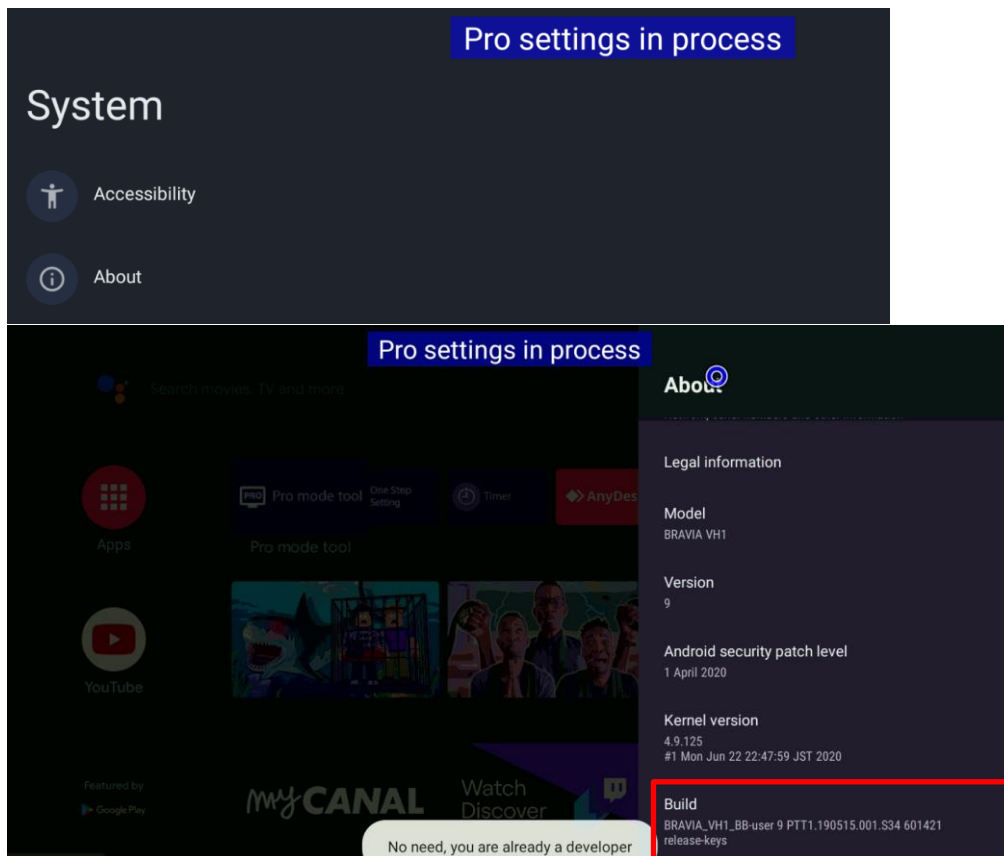

- Go to Settings > System > Developer mode and enable ADB debugging and “stay awake” option

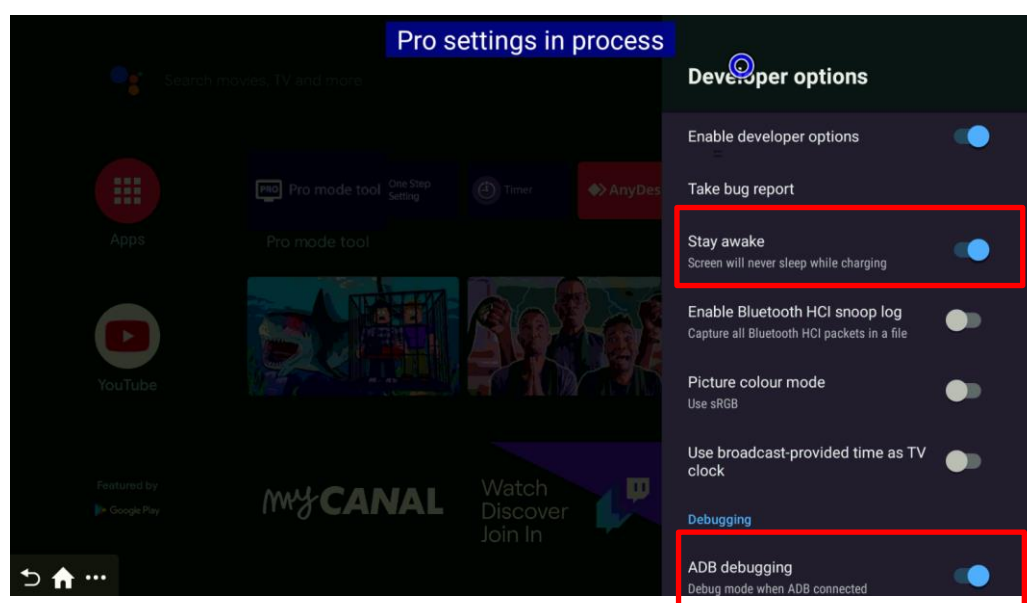

3.3 Enable IP Control under settings.

a) Go to settings > Network & Internet and home network settings

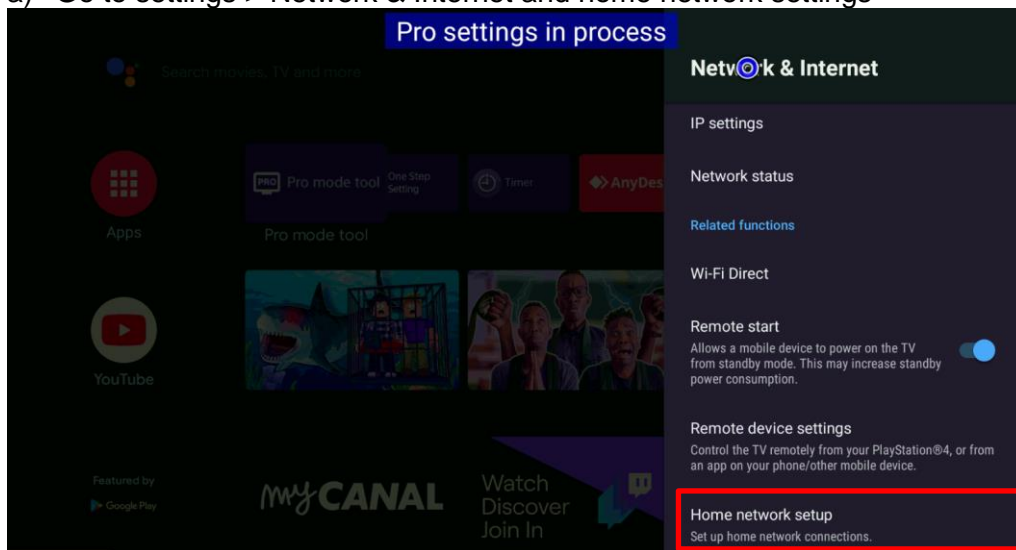

b) Go to IP Control, set the **authentication to None** and enable **Simple IP Control**

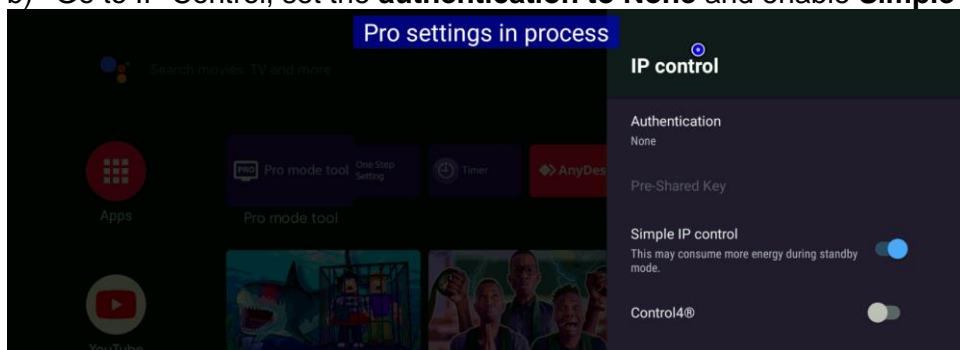

3.4 Installation of apks.

Press “Home”, go to settings and select the **first option “pro settings”**

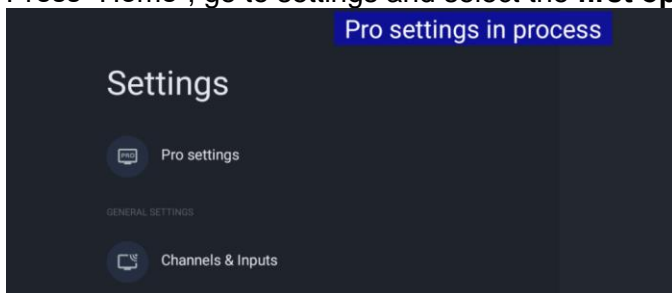

- Allow WebAppRunTime to access photos, media and files when the pop-up appears
- Insert your USB drive with the latest Connect for TEOS Receiver and Signage for TEOS Player apk available on it (must be in the root of your USB stick to be detected)
- “Install APK”** option in the BRAVIA pro setting menu will appear

- (To install if used) Connect for TEOS Receiver.apk



- Signage for TEOS Player.apk



- (If CLOUD platform is used) Cloud Control for TEOS.apk

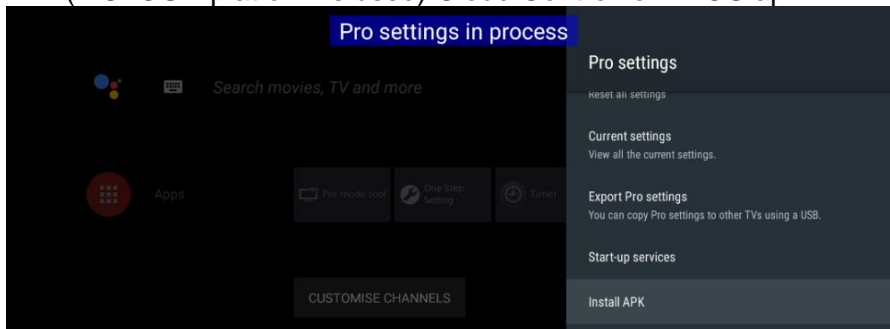

- d) Select the Connect for TEOS Receiver and Install the TEOS Receiver App

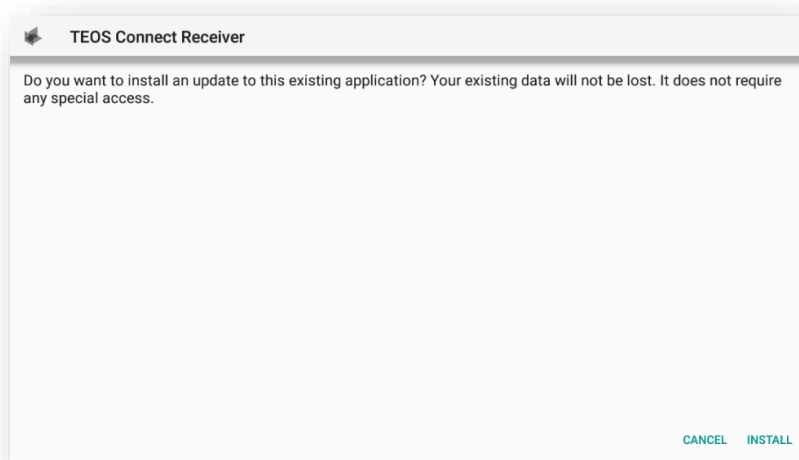

- e) **Open “Connect for TEOS Receiver” application.** The first time the application is opened, you will see a configuration page (used to start the Connect for TEOS Receiver service). After that you can press home and follow the rest of the process.

3.5 Privacy permissions to TEOS Apps.

- f) Open settings > privacy > special app access > display over the apps and allow TEOS Connect and Android player

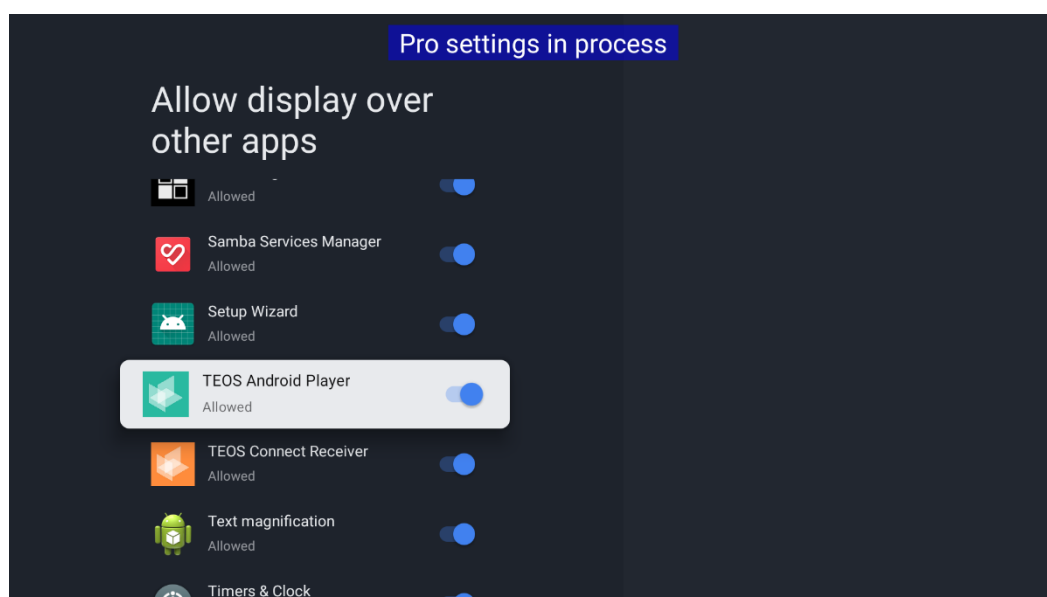
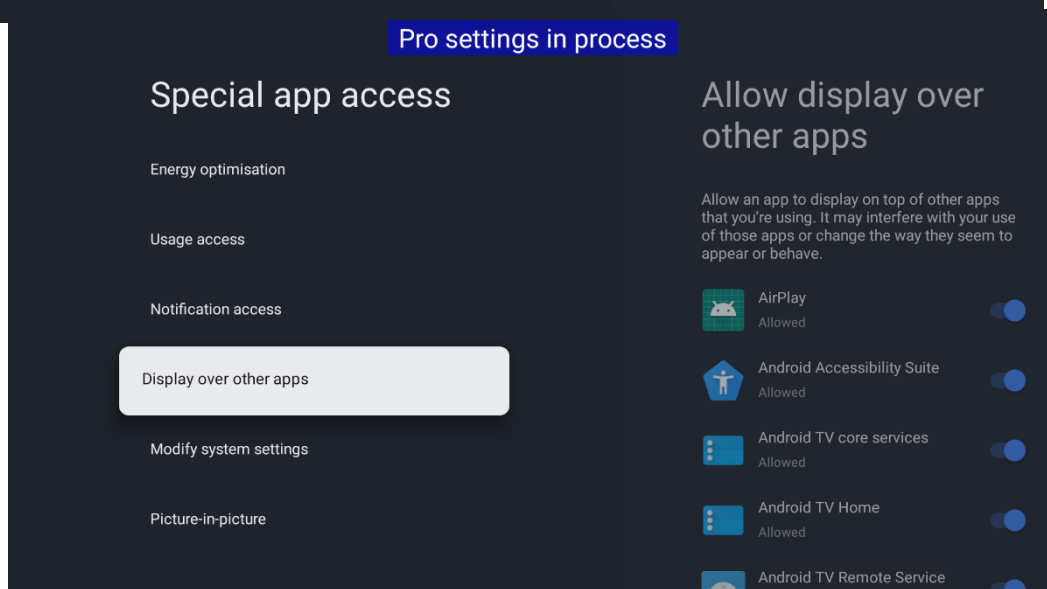
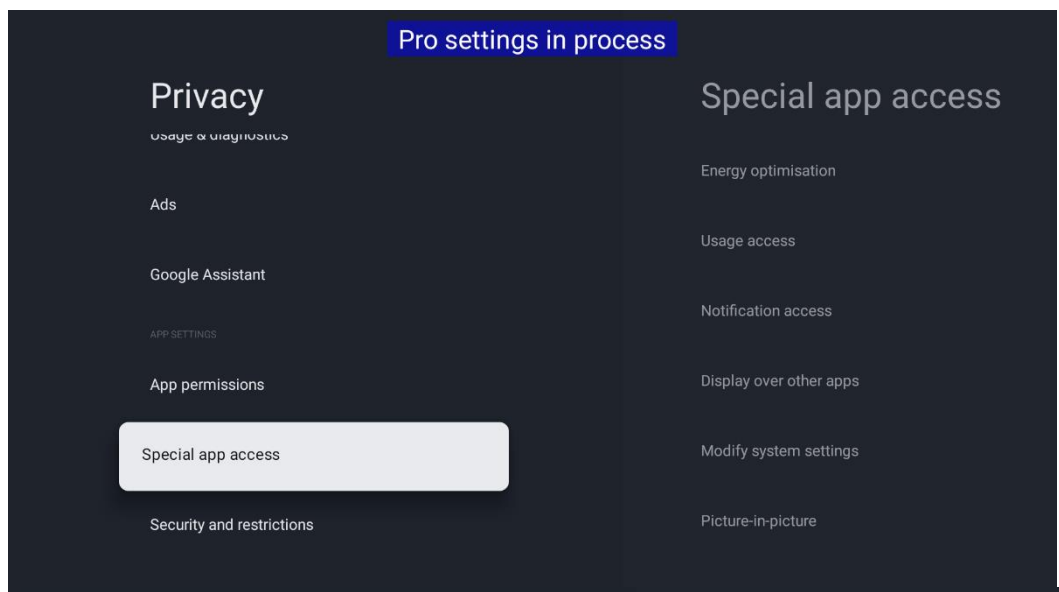

Go back to settings > apps and go to the TEOS apps. You will need for each app to give the

permissions

- For TEOS Cloud Control: Storage
- For TEOS Android Player: Storage and Camera
- For TEOS Connect Receiver: Camera, Location, Microphone and Storage

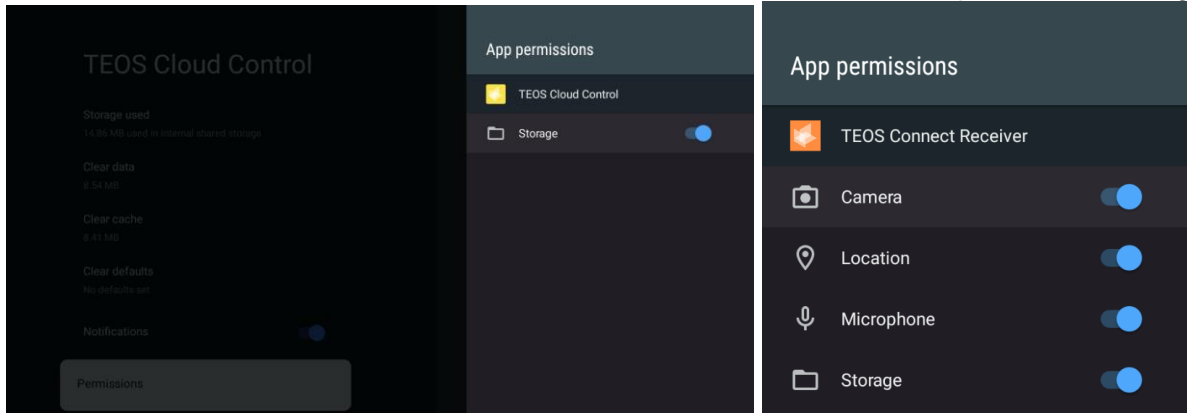

3.6 Pro settings configuration.

- g) Go back on pro settings > install Signage for TEOS App using the same process as you installed Connect for TEOS
- h) For Touch usage, install Touch-Assistant and Touch-KeyBoard going into settings > pro settings and the start-up services. Remote firmware Update Service need also to be enabled as well as BRAVIA Web Control UI

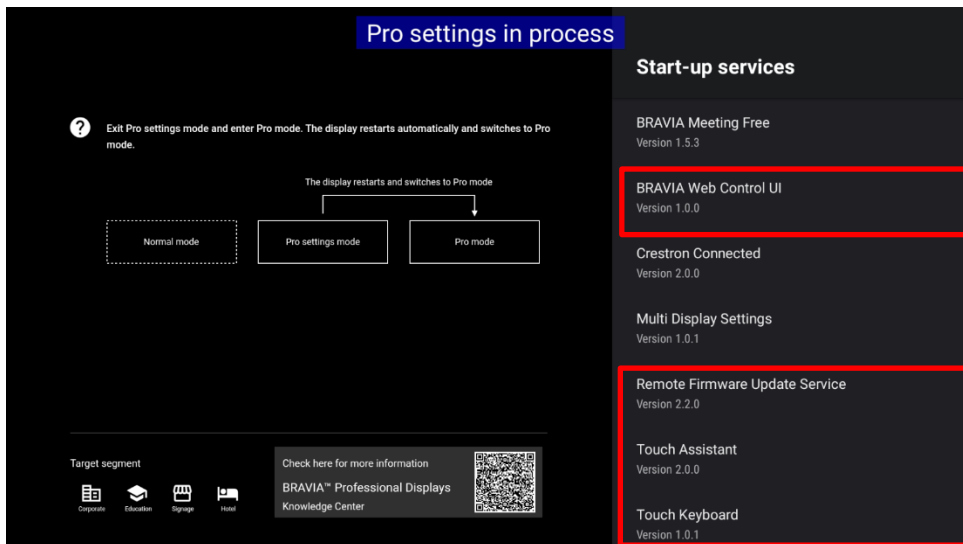

- i) Activate "Remote firmware update Service" (useful for TEOS firmware upgrade management for example)

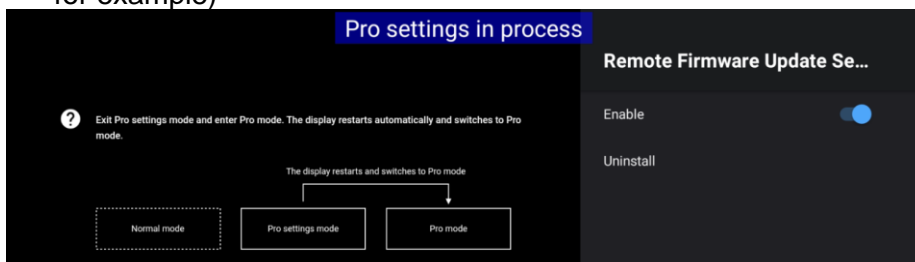

When activating “remote firmware update service” an automatic message appears to make the installation of the app, follow the installation points and reboot the device.

j) Activate “BRAVIA Web UI” (useful for the management of the BRAVIA pro settings remotely)

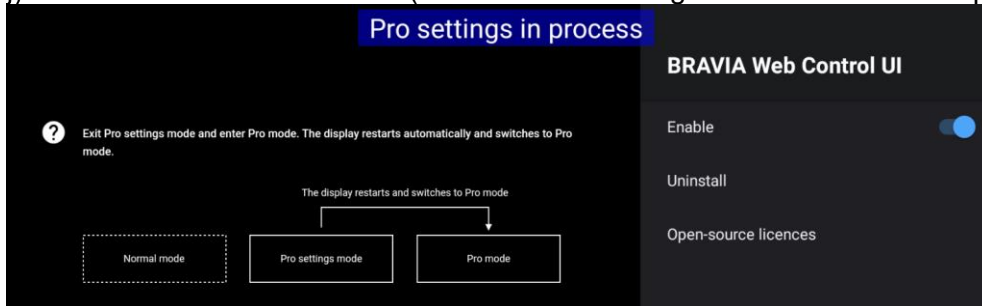

Define the password by default under “Admin password” a password for the BRAVIA Web UI access, **password to add by default is sony1234**

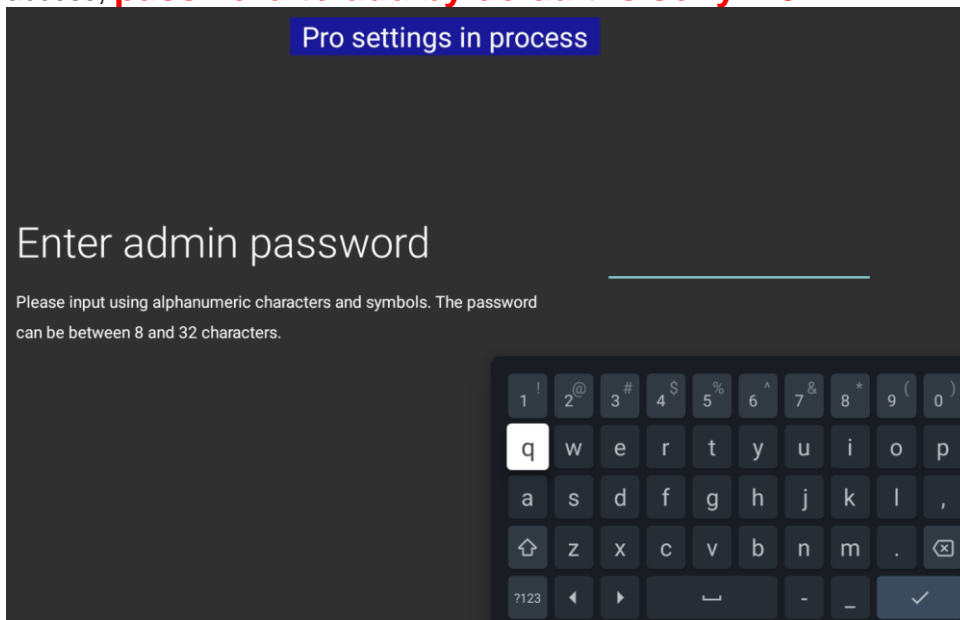

3.7 Setup the Touch-KeyBoard by default (**optional for wayfinding**)

a) Go to settings > System > keyboard and Select Manage Keyboards

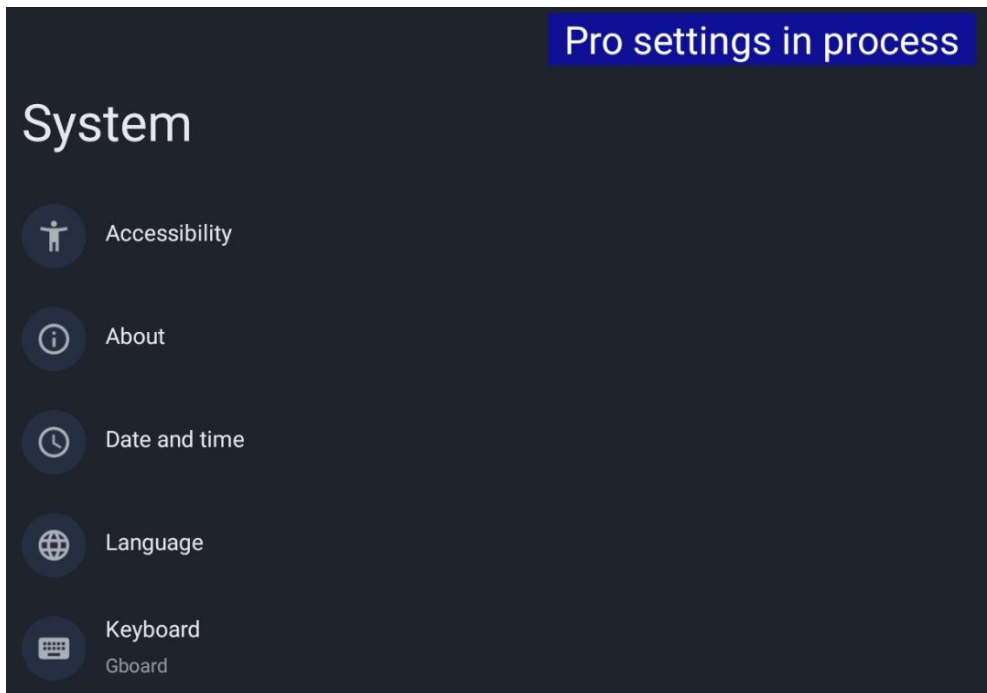

a) Enable Touch Keyboard

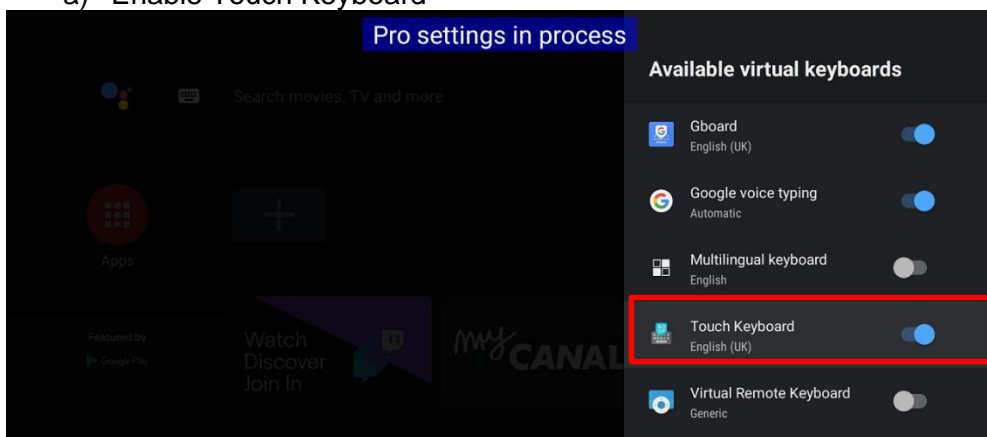

b) Under Current Keyboard, select the Touch-keyboard

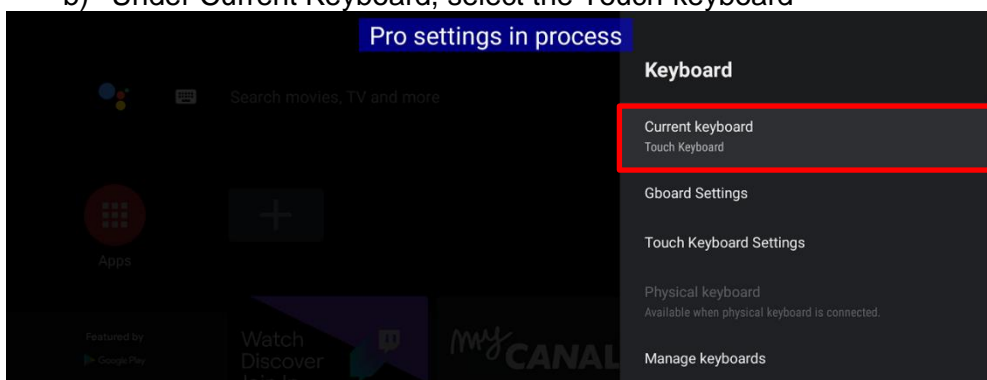

Touch-KeyBoard, use the system language directly and can propose other language that can be setup manually under Touch-keyboard Settings

If your device is preconfigured with touch keyboard enabled and not allowing you to use the virtual keyboard with remote, go to settings > system > keyboard > Manage keyboard and select again Gboard

3.8 Go to pro settings to allow TEOS Apps & Configure your BRAVIA

k) Go to Home Settings > Pro Settings > apps

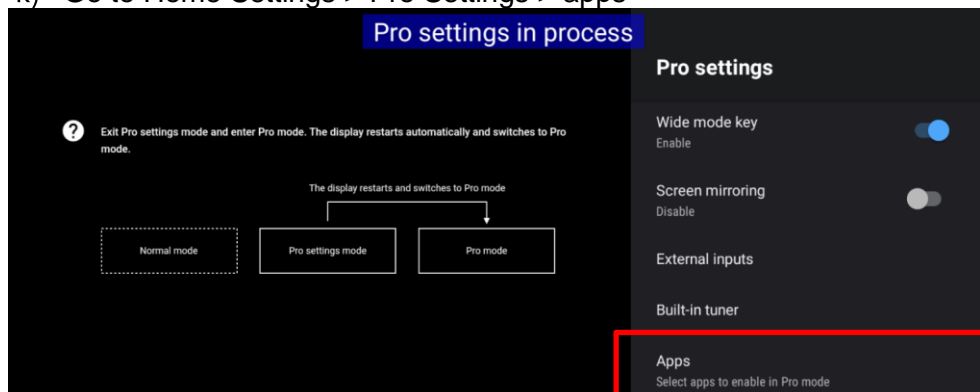

enable all the installed apps (Signage for TEOS App, Connect for TEOS Receiver, Cloud Control for TEOS and Touch keyboard)

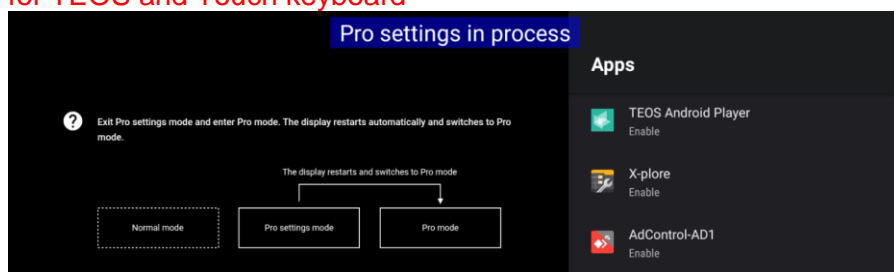

Let Touch-assistant apps disabled

l) Go to Home Pro Settings > Auto wake-up on Signal

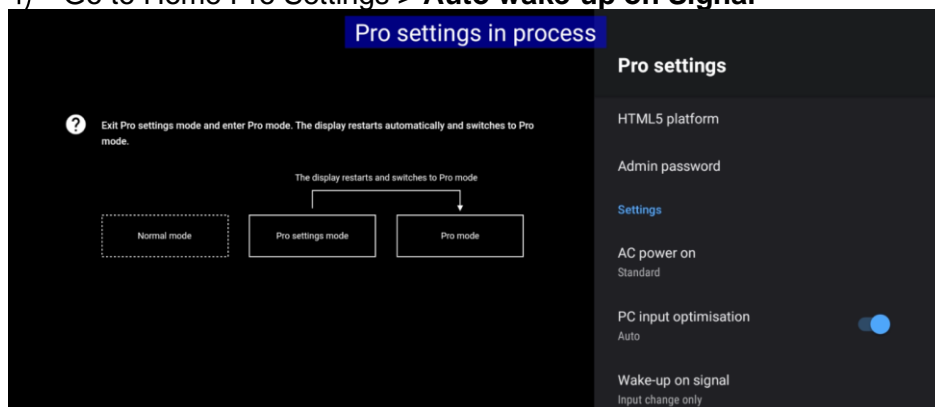

m) Under wake-up on signal, select **Input Change only**

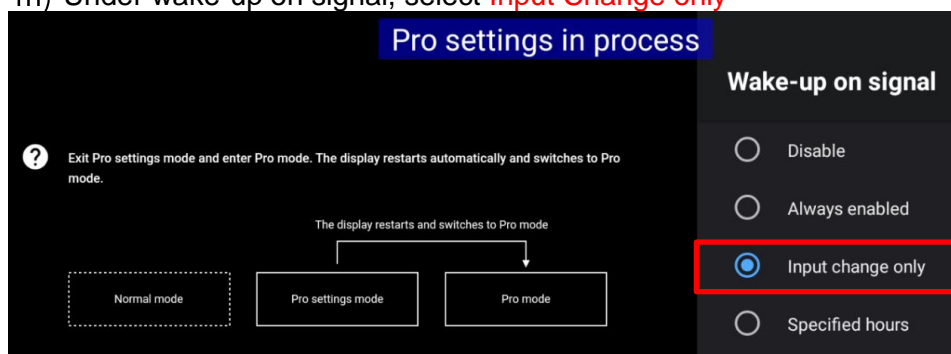

n) Under pro settings, go to **external input**

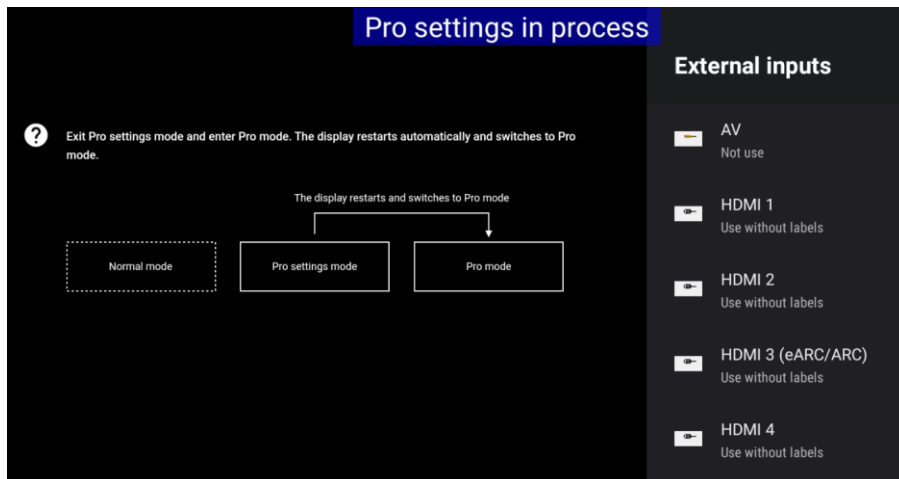

o) Under External input, select each input and enable “use without labels”

p) Go to Developer Option:

- Enable store function
- Enable Power State Control by app

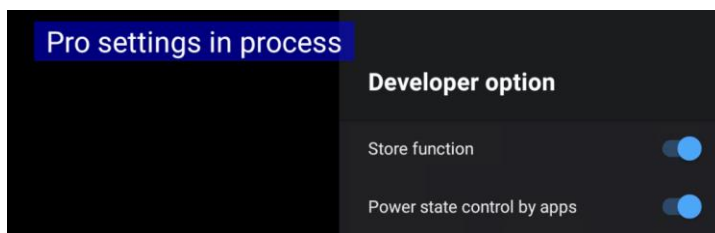

3.9 Finalize the installation by starting pro mode

When all the pre configuration of the BRAVIA is done, the last step is the connection of it into the network. Make sure network (DHCP or static) as been prepared and review the date and time of the device accordingly with time zone and NTP if required and device doesn't have access to the network.

To Configure Network, go to settings > Network and Internet and setup the device in Static IP if there is no DHCP on the network

For NTP, go to settings > pro settings and NTP server to set it up, pro mode need to be enabled to take the NTP configuration into account.

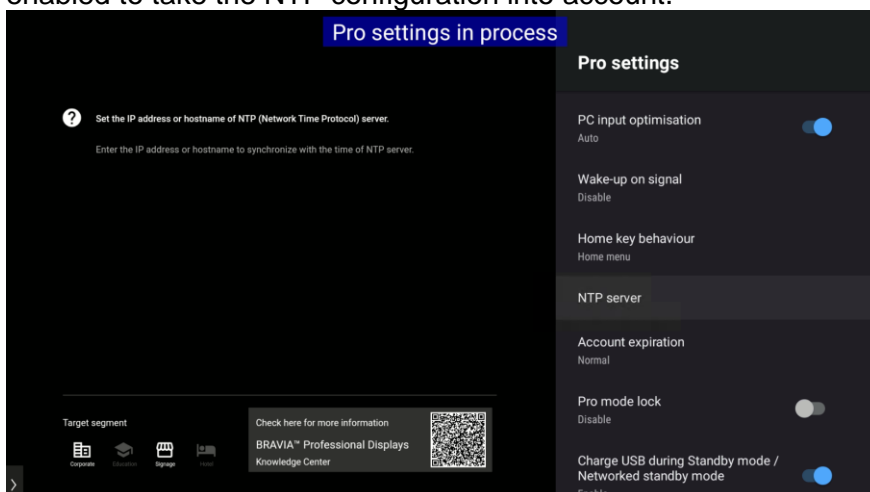

Time zone configuration can be done under settings > System > date and time > set time zone

- a) Go to pro settings and activate pro mode

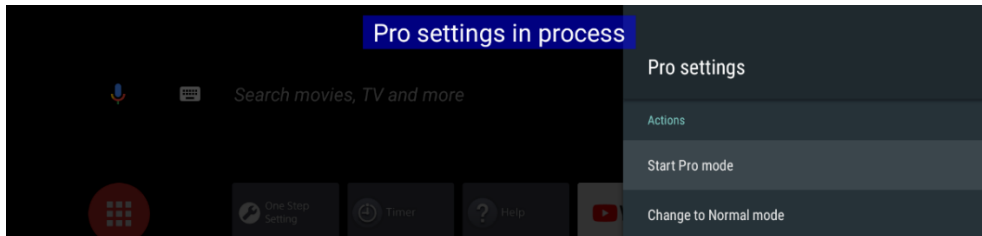

- b) The BRAVIA will reboot and show Signage for TEOS App waiting for content that will be setup into TEOS.

4. Add device in TEOS

4.1 When using TEOS on premise

Go to Manage for TEOS Interface > Administration > Device management. You have different methods to add devices: from an excel Import, from auto discovery option or adding It manually.

We will add in this case manually a new device, for that press on "add device"

- a) Insert the room or BRAVIA name
- b) Select "display" as device type
- c) Select Sony as device brand
- d) Model will be automatically field
- e) Insert the IP address of the device**
- f) Select the license type
- g) Add the device into a device group (create before a group in site configuration)
- h) Press **save**

Make sure your BRAVIA is linked to the device group (meeting room type).

Note: If the device is not reachable via network, or you don't have license for It, you will get a message on top of this tab. If the device is connected and the configuration done, you must be able to see It in green in both power status and behavior status.

<div> <div>AV Devices</div> <div>On this page you can add and manage AV devices such as displays, projectors or tablets and control them remotely, check their content, status and much more.</div> </div> <div> <div>Add non-cloud device</div> <div>Auto discover</div> <div>Import devices from Excel</div> </div>								
Connecting cloud-controlled devices				Connecting Non-cloud-controlled devices				
Refresh	Name	Device model	IP Address	Status	Behaviour status	Device type	License type	Localization
	Dave 10" Tablet	Sony TEB-10SLB	Cloud: d_CF0AB1	?	Unknown	Tablet	Tablet	Dave House Ground Floor
	Dave 7" Tablet	Sony APFC-7XPL	Cloud: d_4F3FC4	?	Unknown	Tablet	Tablet	Dave Bedroom
	Dave Home Bravia	Sony KD-49XH8096	Cloud: d_F230FC	?	Unknown	Display	Meeting Room	Dave Lounge
	Gurpreet's meeting room 2 First floor	Sony APFC-10SLB	Cloud: d_A905F8	On	Room Booking	Tablet	Meeting Room	Gurpreet Meeting Room 2 (First floor)
	Gurpreet's meeting room 1 Ground floor	Sony TEB-10SLB	Cloud: d_713CE7	On	Room Booking	Tablet	Meeting Room	Gurpreet Meeting Room 1 (Ground floor)
	Gurpreet Desk booking tablet	Other TD-0350	Cloud: d_329712	?	Unknown	Tablet	Tablet	Gurpreet's Desk 1
	Gurpreet's 43" Bravia	Sony FW-43BZ35F	Cloud: d_24D5A0	On	External input	Display	Signage	Gurpreet's Open space
	Gurpreet's player	Other AAV-X96-Max+	Cloud: d_6A5061	On	Presentation	Player	Signage	Gurpreet's Open space

By pressing to the virtual remote, TEOS will do a first adb request to your BRAVIA. **BRAVIA will after ask to allow the connection (debugging), for a security measure** which needs to be done when the ADB connection is setup for the first time, you need to authorize the RSA key from the TEOS server, once this is accepted and saved into the local configuration file the connection can be setup at any time when the display is online. You will have to accept the connection by Manage for TEOS to be able to see the snapshot from the screen.

Edit
 Delete
 Execute command
 Update screen

When trying to install a new App in TEOS via Site Management > Service management, and in the device press test ADB, TEOS is doing the same request to the device.

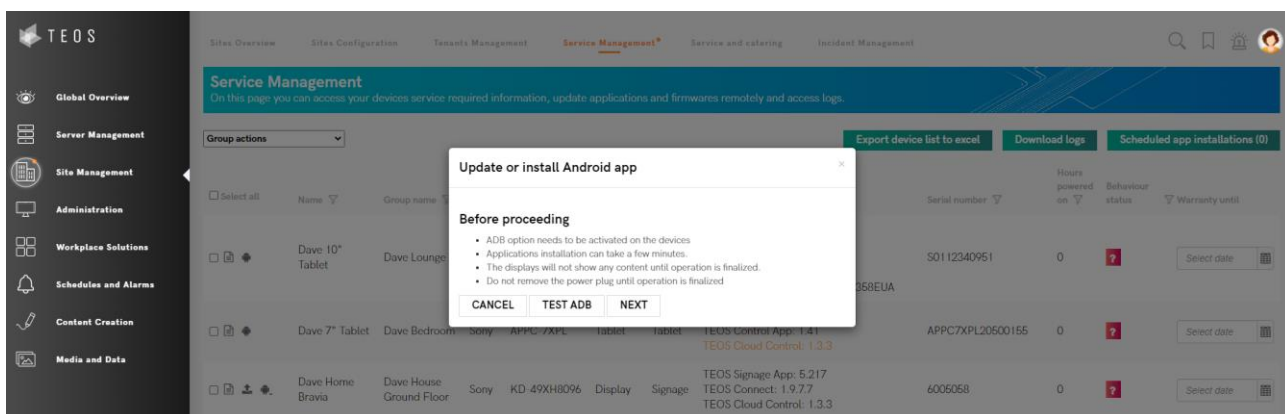

To allow this ADB debugging you have 2 options:

1. Most simple one is by using the real device remote
2. The second one if you IP Control is ON is by using the enter button + right arrow + enter button

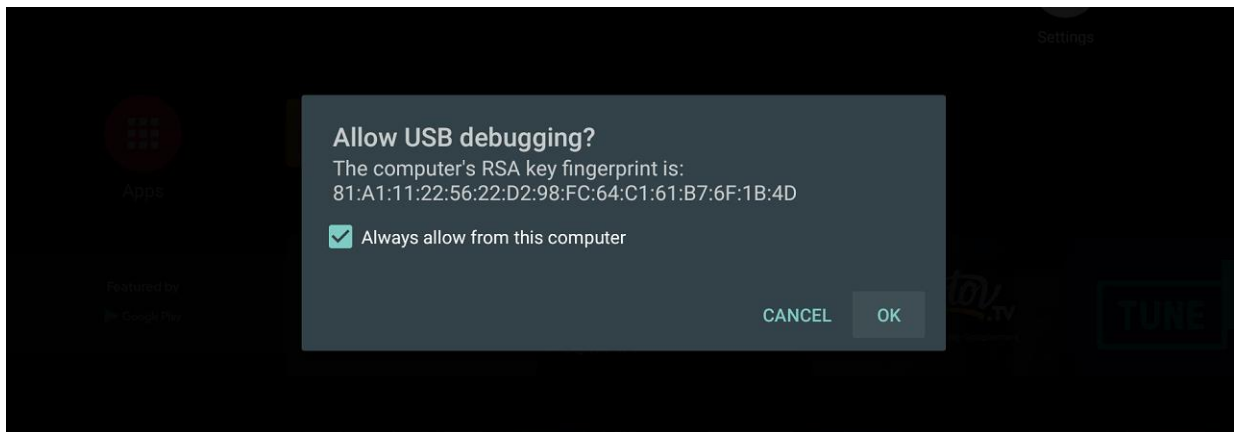

As soon as the it is allowed, you will be able to see the interface of the device into your virtual remote or inservice management, you can test again adb and see it “online”.
If the operation failed, a deep reboot (pressing the reboot button of the virtual remote) and opening again the virtual remote will request again for adb connection.

4.2 When using TEOS on Cloud (from version 3.0)

Go to your Manage for **TEOS CLOUD Interface** > Administration > Device management.
We will add in this case manually a device to the cloud, for that press on the drop-down button on "Connecting cloud-controlled devices" to see the password **automatically regenerated every 1 hour** to insert in the device

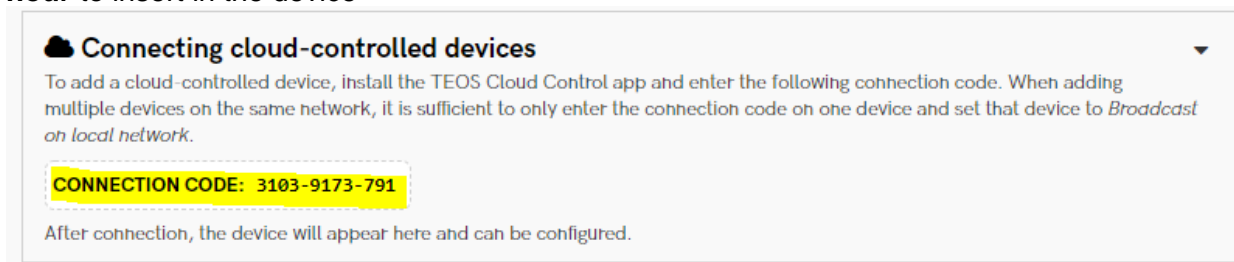

Now from the device, make sure it is connected to the internet. Open the app Cloud Control for TEOS (version 1.4.2 minimum) and insert the password, press connect.



The device will then connect automatically to your cloud account without any additional action.

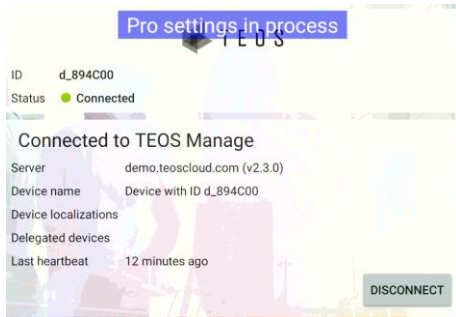

The ID shown in the device will appear in the AV device list after a refresh of the page and will be shown and this end of it.



You can then setup it by clicking on the edit button:

- i) Insert the room or device name
- j) Select "display" as device type
- k) Select Sony as device brand
- l) Model will be automatically field
- m) Select the license type
- n) Add the device into a device group (create before a group in site configuration)
- o) Press **save**

SONY



Visit us on

<https://teos.solutions>

© 2023 Sony Corporation