

Install TEOS Apps on BRAVIA for Manage for TEOS

Document revision 1.1

Description

This guide explains how to set-up your Professional BRAVIA with Android 8 and 9 to use both the Signage for TEOS App and Connect for TEOS Receiver at the same time, touch screens apps, on the same BRAVIA with Android 8.0 and Android 9.0

This procedure should be used with Manage for TEOS Server **from version 2.2** to push configuration like **Signage, Meeting Display, Wayfinding** etc.

This procedure is the one used for all the **preconfigured “/TM” (for Manage for TEOS) BRAVIA**

Requirements

- A Professional BRAVIA with **Android 7, 8 or 9**
- Monitors from 2017 are all compatible with Android 8, please refer to Professional Manual to check the latest firmware version and Models of BRAVIA
- An **Internet access (for Connect for TEOS license in standalone mode)**
- **A set of USB keys formatted in FAT32** (one per BRAVIA, to parallelize process)
- A **USB key formatted in FAT32**, with on the **root** folder 1 file, for Android 8 upgrade
 - **Download** the *.pkg for BZ35F models [here](#) (file must be alone at root)
- A **USB key formatted in FAT32** with on the **root** folder *.apk files:
 1. **Connect for TEOS Receiver (please refer to the release note to find the latest apps available)**
 2. **Signage for TEOS App (please refer to the release note to find the latest apps available)**
 3. **Cloud Control for TEOS App (please refer to the release note to find the latest apps available), if your device will be used in the CLOUD**
- For Touch usage on BRAVIA, A **USB key formatted** with on the **root** *.apk files:
 1. **Touch Assistant**
 2. **Touch Keyboard**
 3. **Both apps can be found under <https://bit.ly/sonypsetech> in TEOS - Corporate Solutions > 3 - BRAVIA for TEOS > Apps for TEOS > Keyboard & touchscreen**
- Using Manage for TEOS, the installation of the apps can be done from TEOS
- **Please refer to <https://bit.ly/sonypsetech> to find all the details, apps, setup if needed (under TEOS – Corporate Solutions)**

Table of Contents

1. Check and update your BRAVIA firmware.....	4
2. Understanding of the Pro Mode access.....	4
3. Configuration for TEOS Usage.....	5
3.1 Configurations under BRAVIA Settings.	6
3.2 Under settings enable developer options and ADB.	7
3.3 Enable Guest access (WIFI hotspot) on BRAVIA.	8
3.4 Enable IP Control under settings.	8
3.5 Installation of apks.	9
3.6 Setup the Touch-KeyBoard by default	10
3.7 Go to pro settings to allow TEOS Apps & Configure your BRAVIA.....	11
3.8 Finalize the installation by starting pro mode.....	13
4. Add device in TEOS.....	14
4.1 When using TEOS on premise	14
4.2 When using TEOS on Cloud (from version 3.0).....	16

1. Check and update your BRAVIA firmware

Make sure the language setup of your device is in English: go to *Settings* and choose **English**. You must be in normal or pro settings mode to be able to do the update. Check in what mode you are. For first installation, the device is in normal mode

Check your version of Android, if you are **already in Android 8**, skip this process and go to section 2 “Setup of Monitor”.

First, go to home>Help, the name of the device and the version of firmware is shown in the upper right side.

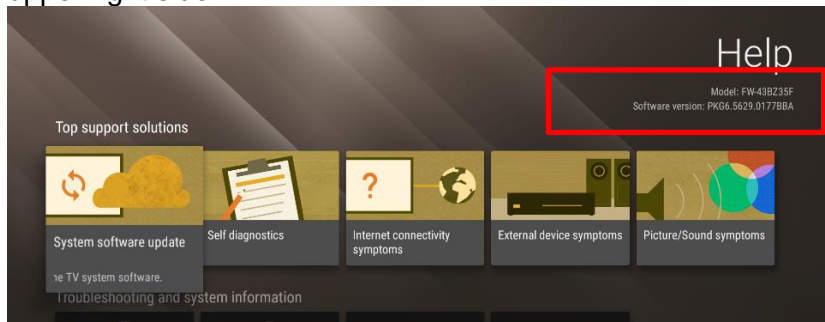

a) Update firmware using internet (internet access needed)

Go to help>system software update and search for a new firmware, the device search for a new firmware and propose to install it. A firmware install can take from 15-30 minutes.

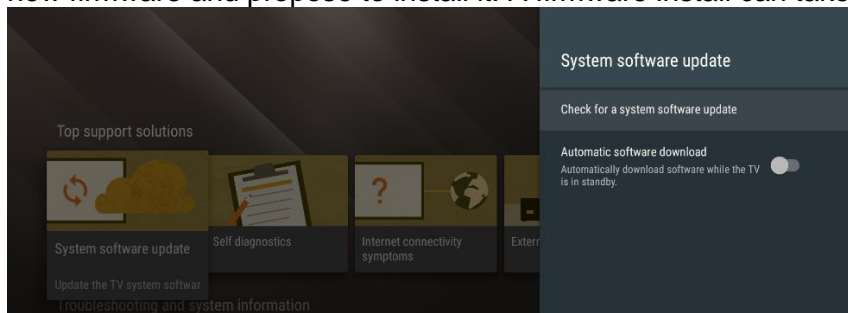

b) Update firmware using USB drive

Go to this website and look for the latest version of firmware. Download the zip file and extract it to the root of a USB stick (a pkg file must be present in the USB stick).

USB request: 2GB of storage, formatted in FAT32

Place the USB stick in one of the ports of the device. The USB is detected and start automatically the installation of the firmware (take around 15 to 30 minutes)

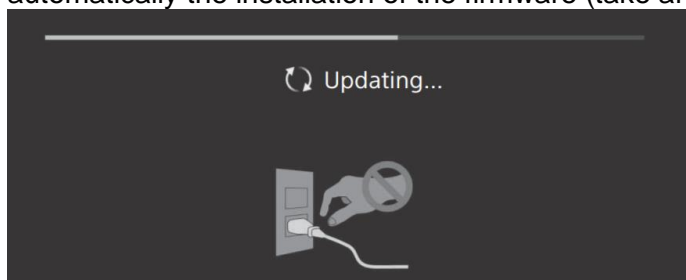

2. Understanding of the Pro Mode access

In [Pro mode], you can use various convenient functions for professional use. Here, we introduce how to change to [Pro mode] and typical functions of [Pro mode].

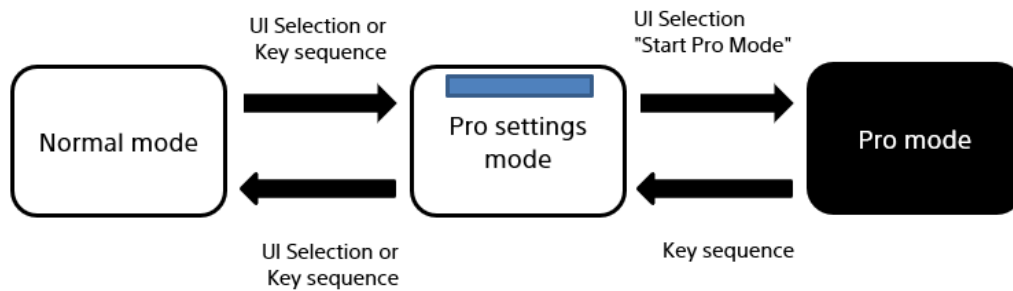

Normal mode: This is the default mode. [Pro mode] functions are not available in this mode.

Pro settings mode: This mode allows you to set various settings of [Pro mode] functions.

Pro mode: This is the professional use where you can use the [Pro mode] functions.

After each switch in each mode, the monitor will reboot.

Key sequence (press the below keys on the remote commander in order within 3 seconds)

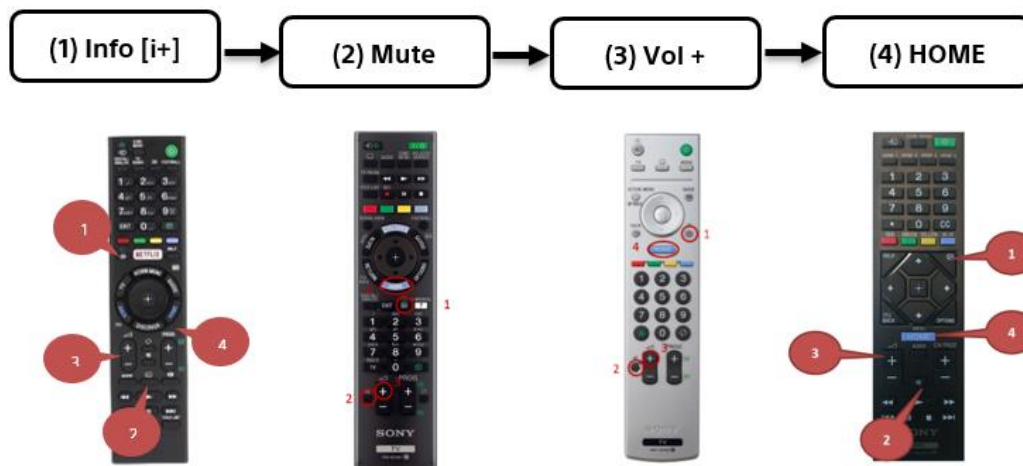

UI Selection (only for FW-XXBZ35F models), this option allows you to switch between the different modes using the Android UI (app view)

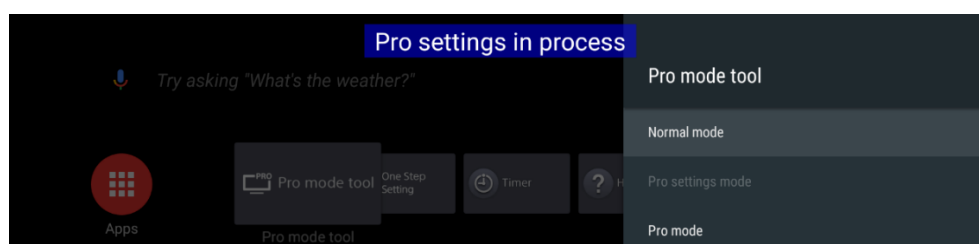

* Initially you cannot change the mode from [Pro mode tool] in [Pro mode]. If you want to change the mode from [Pro mode tool], go to [Pro settings] t [Function restrictions] t [Apps] and change [Pro mode tool] to [Enable] in [Pro settings mode].

3. Configuration for TEOS Usage

To start this procedure, you need to make sure your device is in pro settings and shows pro settings in process. If it is not the case, please refer to the procedure upper.

3.1 Configurations under BRAVIA Settings.

When you are in BRAVIA home menu, go to settings

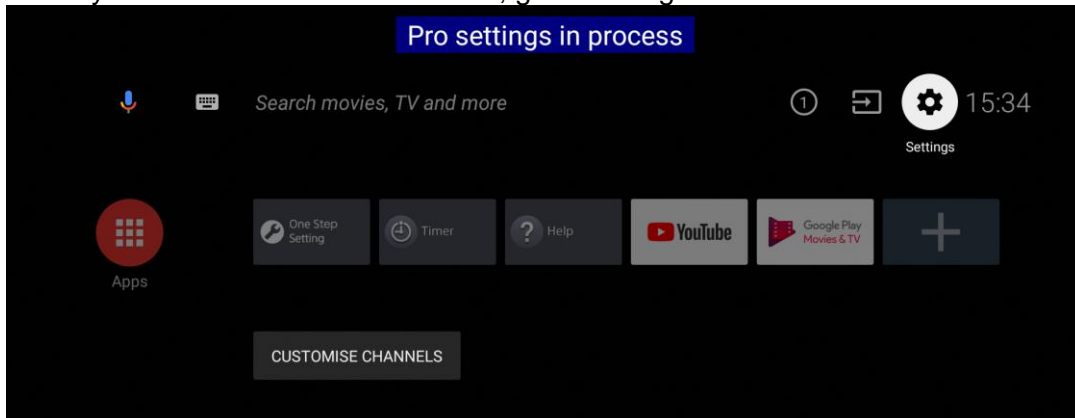

- a) Go to Settings > Date & time > Automatic date & time (if you want to display the correct date and time when BRAVIA is connected, internet access needed)
For Android 9 version, you need to go to settings > Device preferences > Date & time
- Select "use Network time"

From the Pro setting menu, you can define an NTP server for the BRAVIA to stay on time

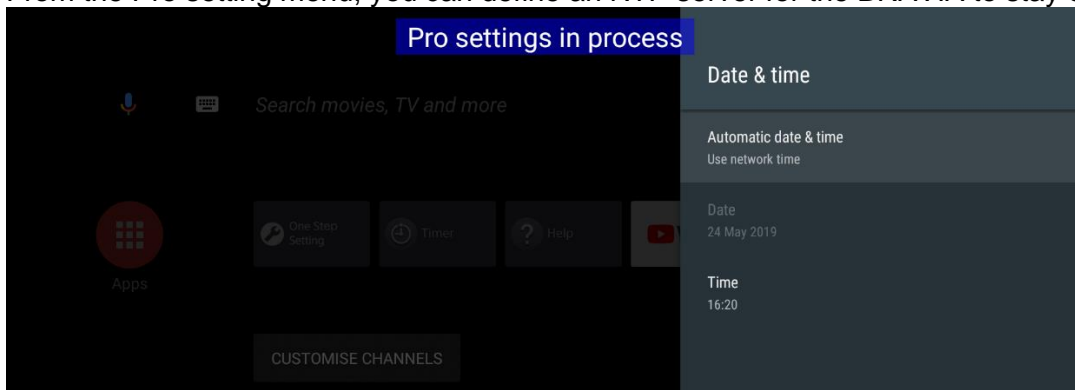

- b) Go to settings > Power > Eco and set power saving, Idle TV standby, Auto shut-off to Off
For Android 9 version, you need to go to settings > Device preferences > Power

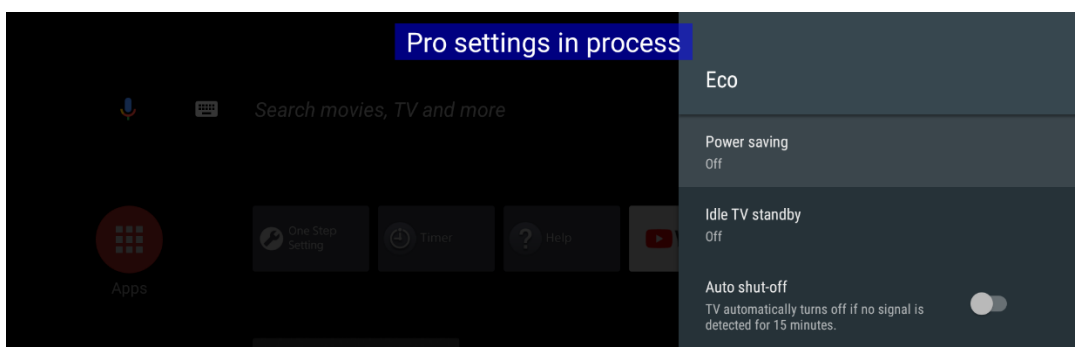

- c) Go to Settings > About > Automatic Software download and make sure it is Off
For Android 9 version, you need to go to settings > Device preferences > About

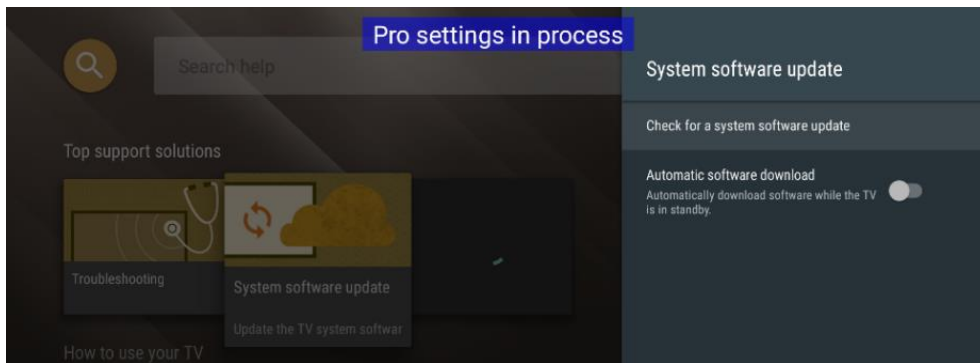

3.2 Under settings enable developer options and ADB.

a) For that go back to Settings > About > Build

For Android 9 version, you need to go to settings > Device preferences > About > Build

- Press 7 times in build option, developer mode will be unlocked

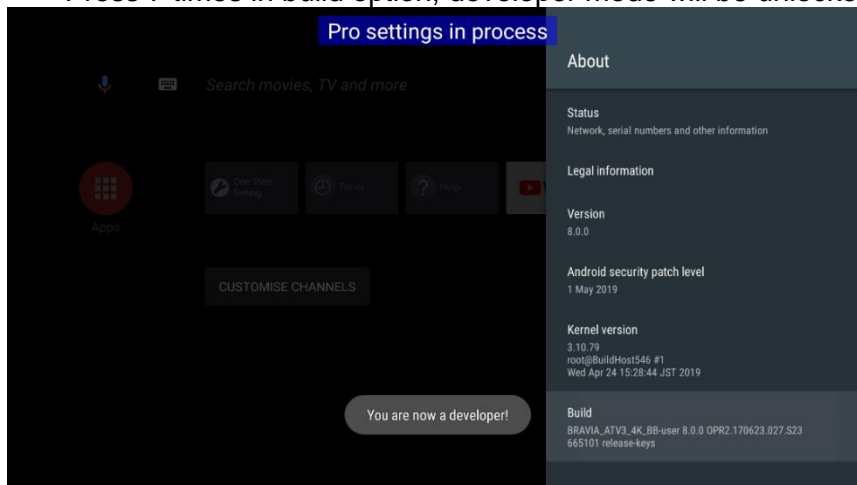

- Go to Settings > Developer mode and enable ADB debugging and “stay awake” option

For Android 9 version, you need to go to settings > Device preferences > Developer options

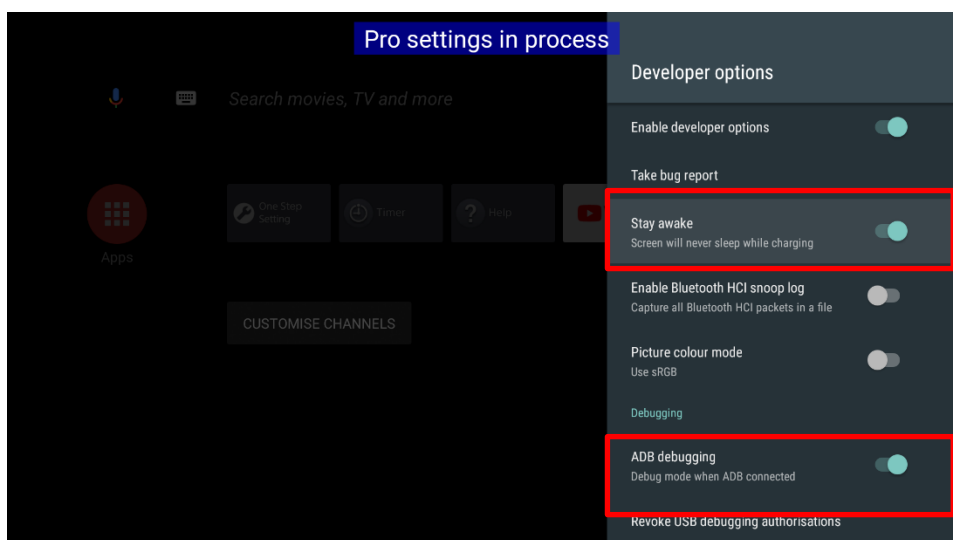

3.3 Enable Guest access (WIFI hotspot) on BRAVIA.

a) Go to settings>network> WI-FI Direct

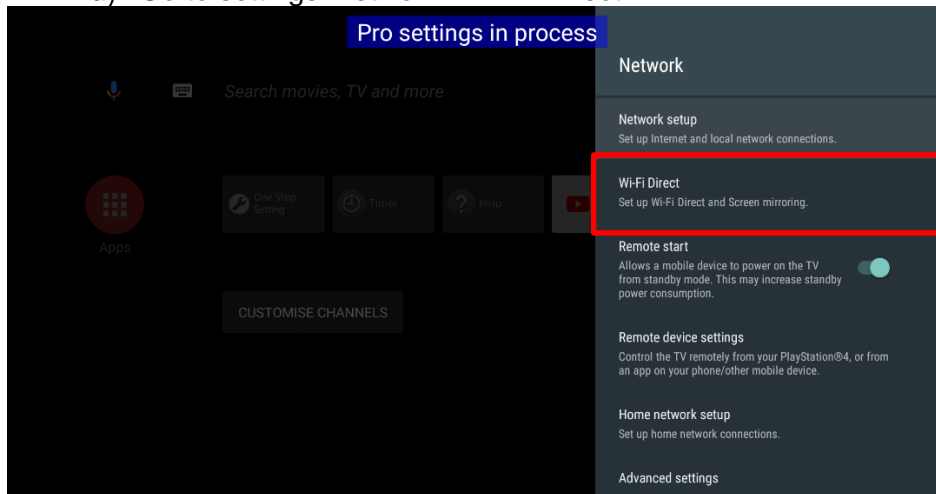

b) Under Wi-Fi Direct, activate "Wi-Fi direct"

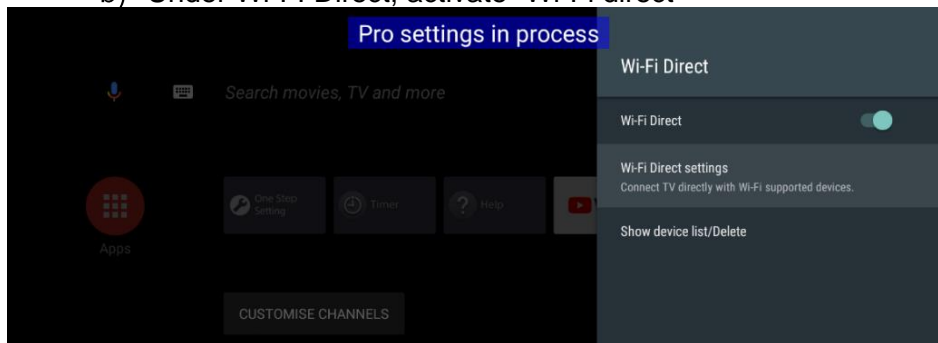

3.4 Enable IP Control under settings.

a) Go to settings > Network and home network settings

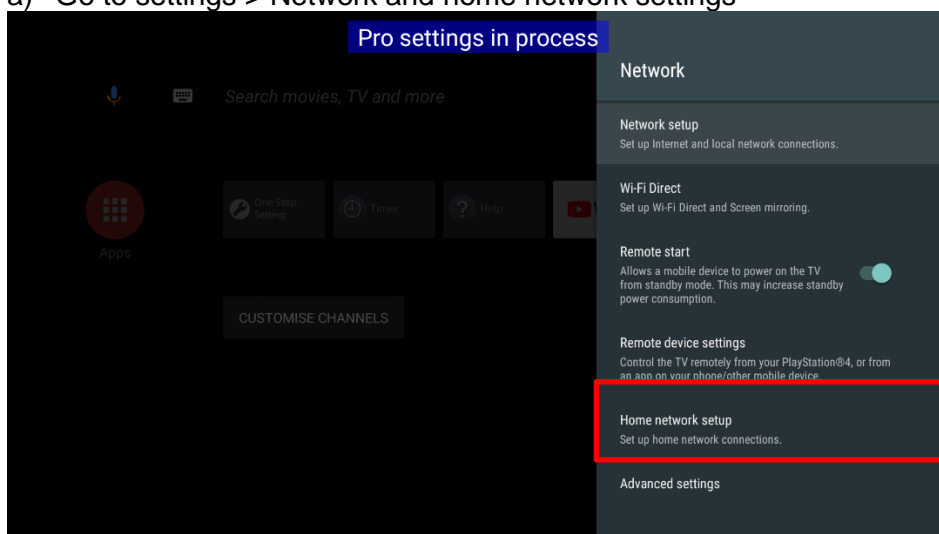

b) Go to IP Control, set the authentication to None and enable Simple IP Control

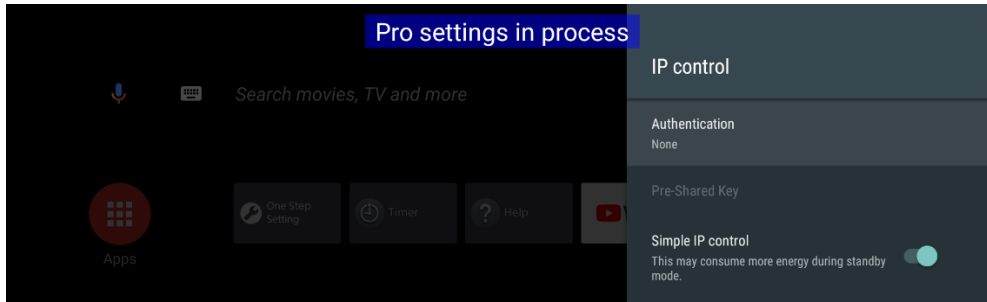

- c) Go back to network configuration. If you want to define a static IP address for your device, you can go to network setup > Expert > Select if you use Wi-Fi or Wired LAN. If you select Wi-Fi, connect to the Wi-Fi network. If you use wired Lan (recommended) go to IP settings and select Static to define you IP address

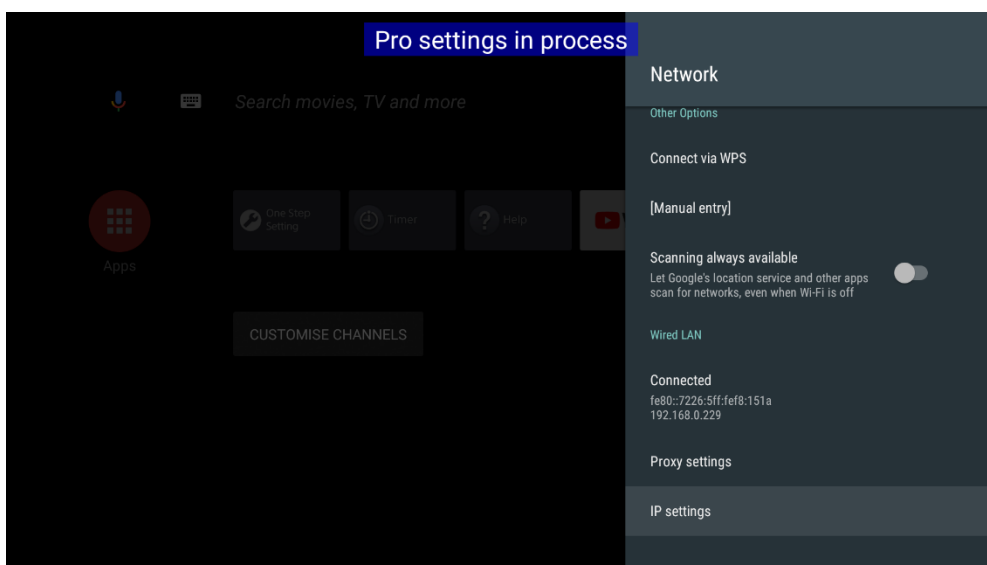

3.5 Installation of apks.

Press “Home”, go to settings and select the first option “pro settings”

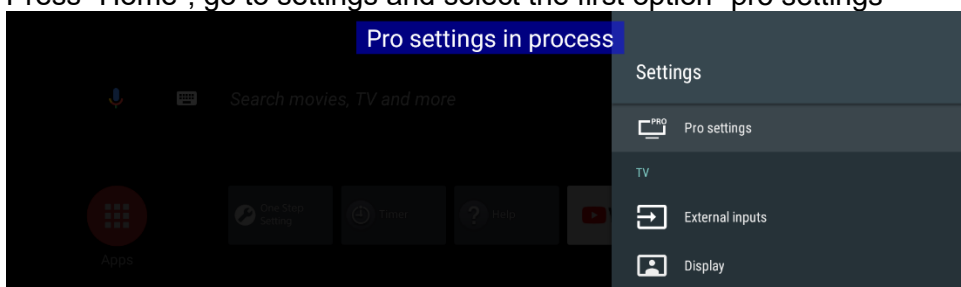

- Allow WebAppRunTime to access photos, media and files when the pop-up appears
- Insert your USB drive with WebAppRuntime and Connect for TEOS Receiver.apk on it (must be in the root of your USB stick to be detected)
- “Install APK” option in the BRAVIA pro setting menu will appear
 - Connect for TEOS Receiver, TEOS Android App and Cloud control app if needed

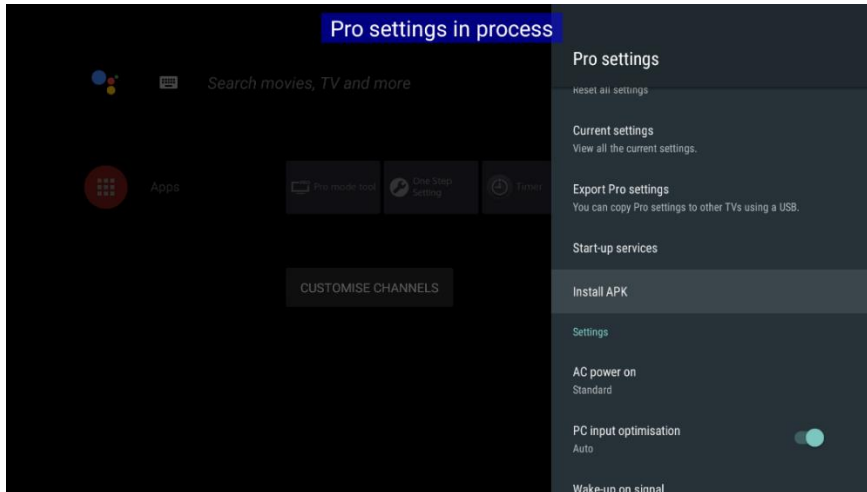

d) Select the Connect for TEOS Receiver and Install the TEOS Receiver App

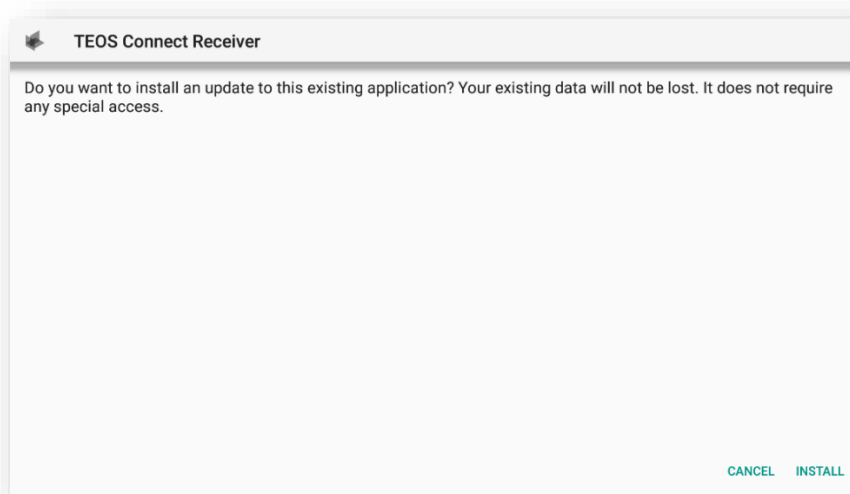

- e) **Open "Connect for TEOS Receiver" application.** The first time the application is opened, you will see a configuration page (used to start the Connect for TEOS Receiver service). After that you can press home and follow the rest of the process.
- f) Go back on pro settings > install Signage for TEOS App using the same process as you installed Connect for TEOS
- g) For Touch usage, install Touch-Assistant.apk and Touch-Keyboards.apk
- h) Touch Assistant**
- i) Touch Keyboard**

3.6 Setup the Touch-Keyboards by default

- a) Go to settings > keyboard and Select Manage Keyboards

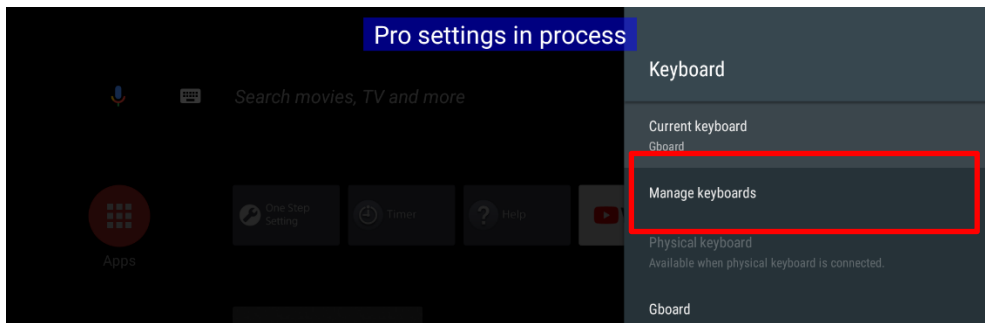

a) Enable Touch Keyboard

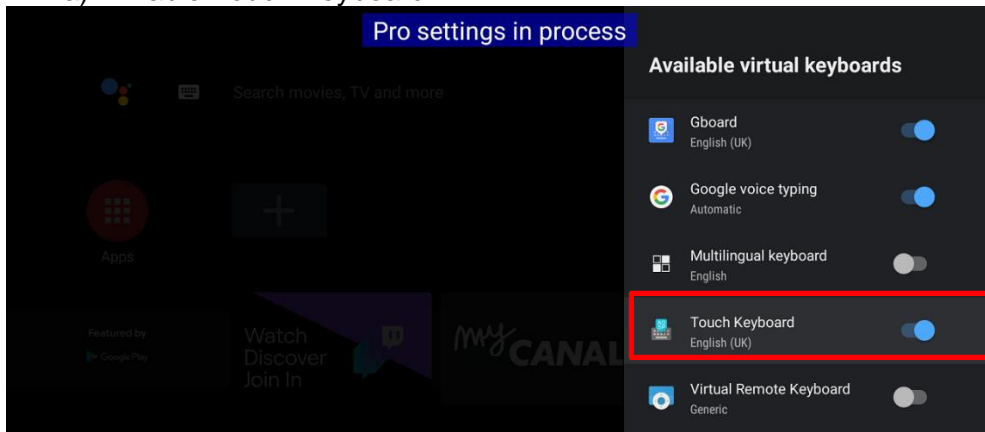

b) Under Current Keyboard, select the Touch-keyboard

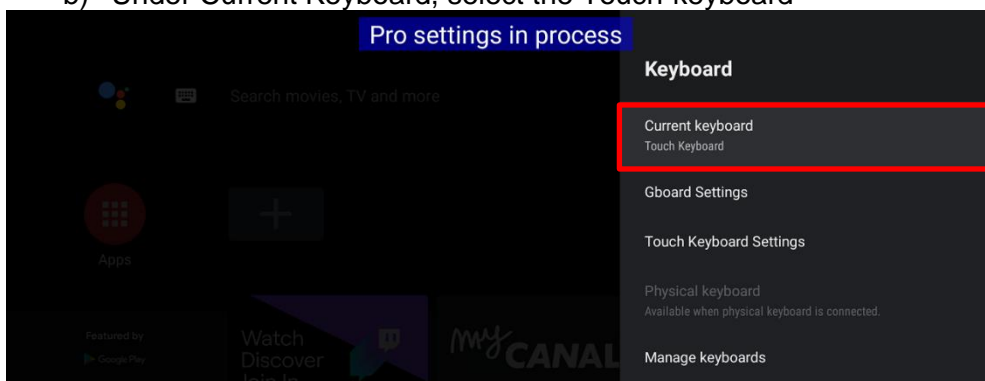

Touch-Keyboard, use the system language directly and can propose other language that can be setup manually under Touch-keyboard Settings

3.7 Go to pro settings to allow TEOS Apps & Configure your BRAVIA

a) Go to Home Pro Settings > Settings> apps and **enable all the installed apps**

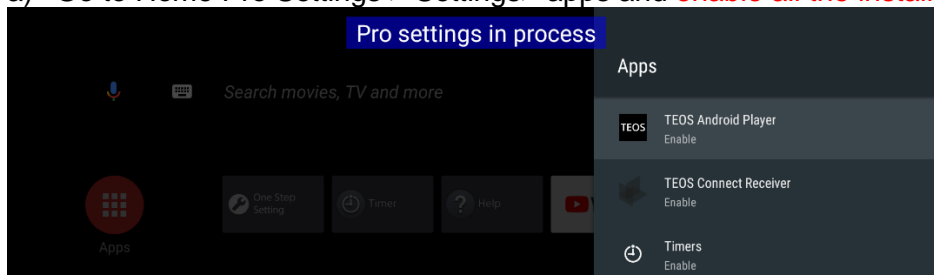

Important, if you are not using Touch-assistant apps (foreground app to return or go to home), you can disable it

b) Go to Home Pro Settings > **Auto wake-up on Signal**

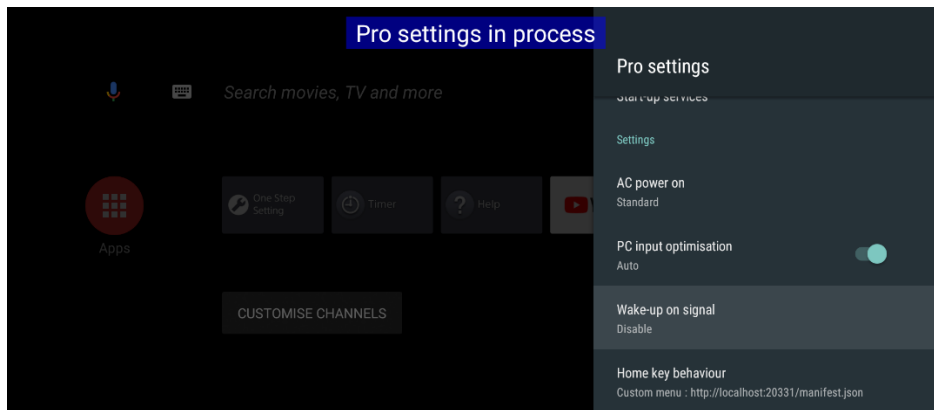

c) Under wake-up on signal, select **Input Change only**

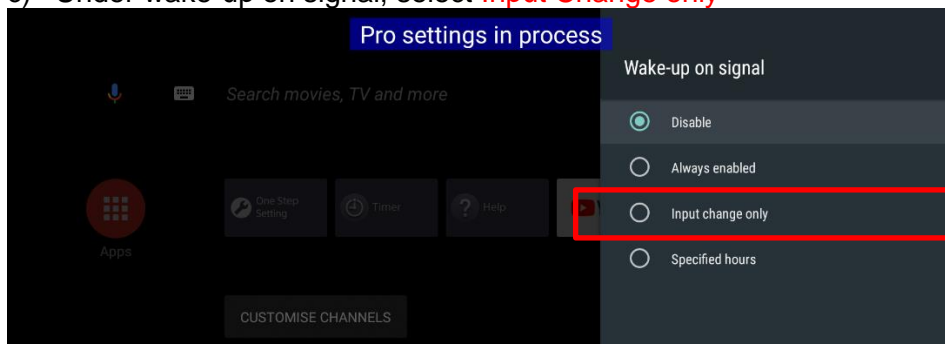

d) Under pro settings, go to **external input**

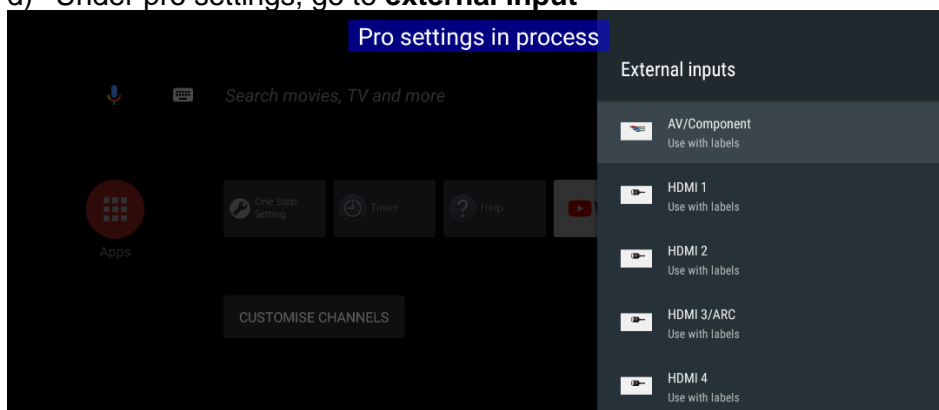

e) Under External input, select each input and **enable "use without labels"**

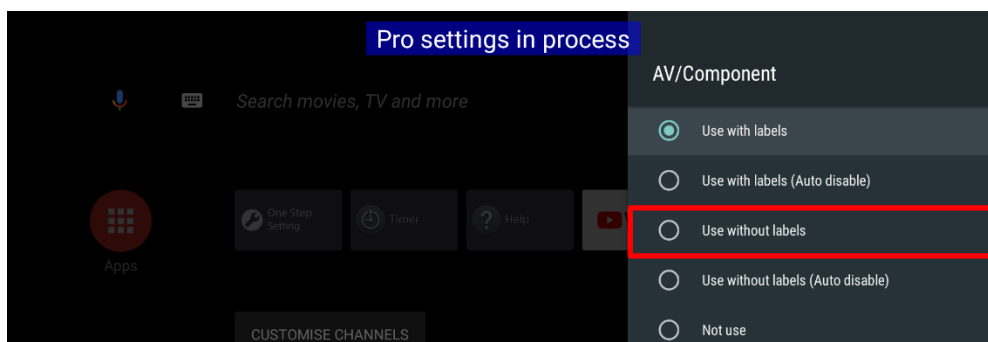

f) Go to Developer Option:

- Enable Power State Control by app
- Enable Web Apps installation

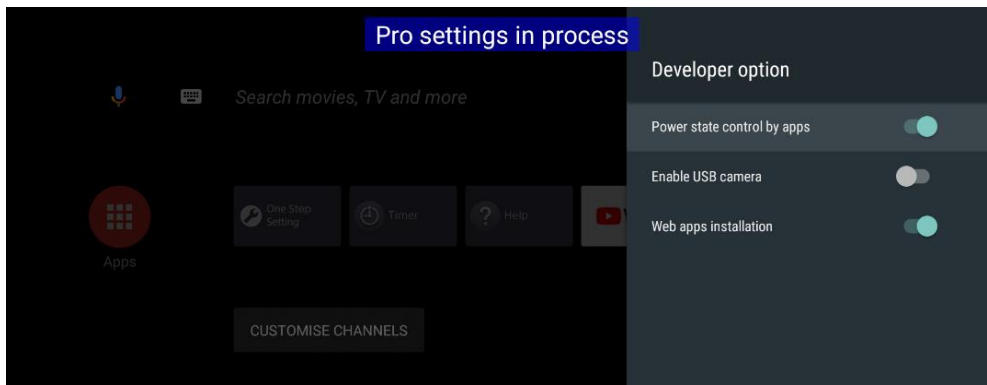

- g) Go pro settings>start-up services
- h) Activate “Remote firmware update Service” (useful for TEOS firmware upgrade management for example)

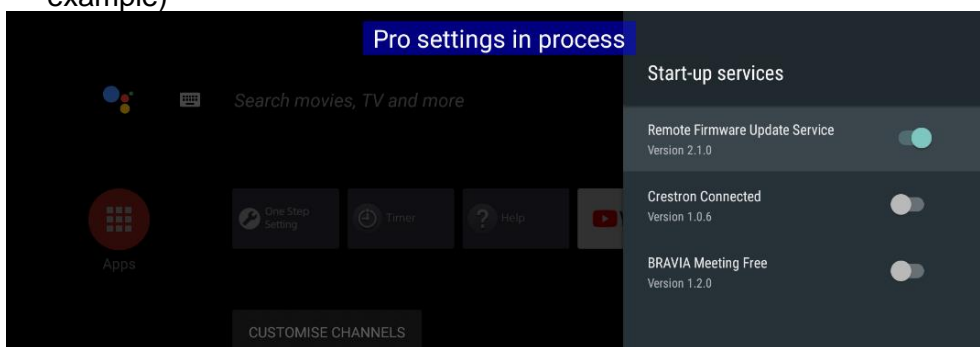

When activating “remote firmware update service” an automatic message appears to make the installation of the app, follow the installation points and reboot the device.

3.8 Finalize the installation by starting pro mode

- a) Go to pro settings and activate pro mode

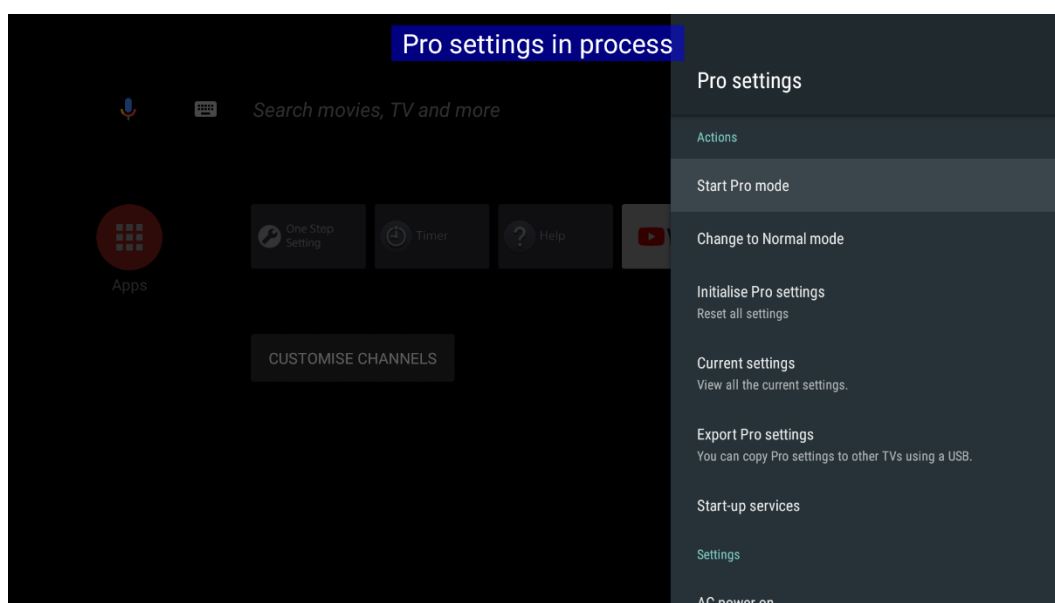

- b) The BRAVIA will reboot and show Signage for TEOS App waiting for content that will be setup into TEOS.

c) Go to pro settings and activate pro mode

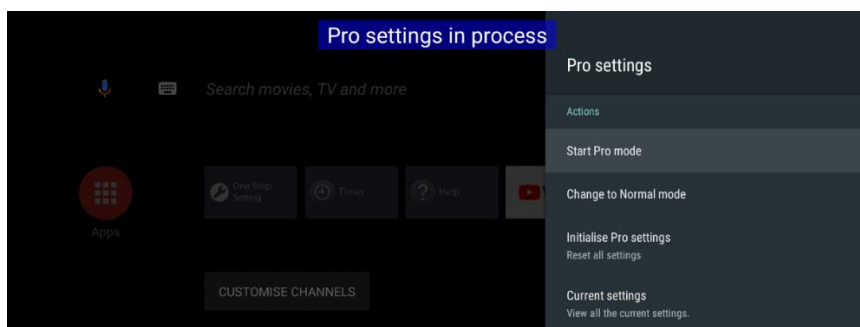

d) The BRAVIA will reboot and show Signage for TEOS App waiting for content that will be setup into TEOS.

Your Professional BRAVIA is now configured for Meeting Display usage, Signage, but also if touch screen apps are enabled for Wayfinding Solution for example.

4. Add device in TEOS

4.1 When using TEOS on premise

Go to Manage for TEOS Interface > Administration > Device management. You have different methods to add devices: from an excel Import, from auto discovery option or adding it manually.

We will add in this case manually a new device, for that press on "add device"

- Insert the room or BRAVIA name
- Select "display" as device type
- Select Sony as device brand
- Model will be automatically field
- Insert the IP address of the device**
- Select the license type
- Add the device into a device group (create before a group in site configuration)
- Press **save**

Make sure your BRAVIA is linked to the device group (meeting room type).

Note: If the device is not reachable via network, or you don't have license for it, you will get a message on top of this tab. If the device is connected and the configuration done, you must be able to see it in green in both power status and behavior status.

AV Devices								
On this page you can add and manage AV devices such as displays, projectors or tablets and control them remotely, check their content, status and much more.								
Add non-cloud device Auto discover Import devices from Excel								
Connecting cloud-controlled devices				Connecting Non-cloud-controlled devices				
Refresh	Name	Device model	IP Address	Status	Behaviour status	Device type	License type	Localization
	Dave 10" Tablet	Sony TEB-10SLB	Cloud: d.CF0AB1	?	Unknown	Tablet	Tablet	Dave House Ground Floor
	Dave 7" Tablet	Sony APFC-7XPL	Cloud: d.4F3FC4	?	Unknown	Tablet	Tablet	Dave Bedroom
	Dave Home Bravia	Sony KD-49XH8096	Cloud: d.F230FC	?	Unknown	Display	Meeting Room	Dave Lounge
	Gurpreet's meeting room 2 First floor	Sony APFC-10SLB	Cloud: d.A90F8	On	Room Booking	Tablet	Meeting Room	Gurpreet Meeting Room 2 (First floor)
	Gurpreet's meeting room 1 Ground floor	Sony TEB-10SLB	Cloud: d.713CE7	On	Room Booking	Tablet	Meeting Room	Gurpreet Meeting Room 1 (Ground floor)
	Gurpreet Desk booking tablet	Other TD-0350	Cloud: d.329712	?	Unknown	Tablet	Tablet	Gurpreet's Desk 1
	Gurpreet's 43" Bravia	Sony FW-43BZ36F	Cloud: d.24D5A0	On	External Input	Display	Signage	Gurpreet's Open space
	Gurpreet's player	Other AAV-X96-Max	Cloud: d.6A5061	On	Presentation	Player	Signage	Gurpreet's Open space

By pressing to the virtual remote, TEOS will do a first adb request to your BRAVIA. **BRAVIA will after ask to allow the connection (debugging), for a security measure** which needs to be done when the ADB connection is setup for the first time, you need to authorize the RSA key from the TEOS server, once this is accepted and saved into the local configuration file the connection can be setup at any time when the display is online. You will have to accept the connection by Manage for TEOS to be able to see the snapshot from the screen.



When trying to install a new App in TEOS via Site Management > Service management, and in the device press test ADB, TEOS is doing the same request to the device.

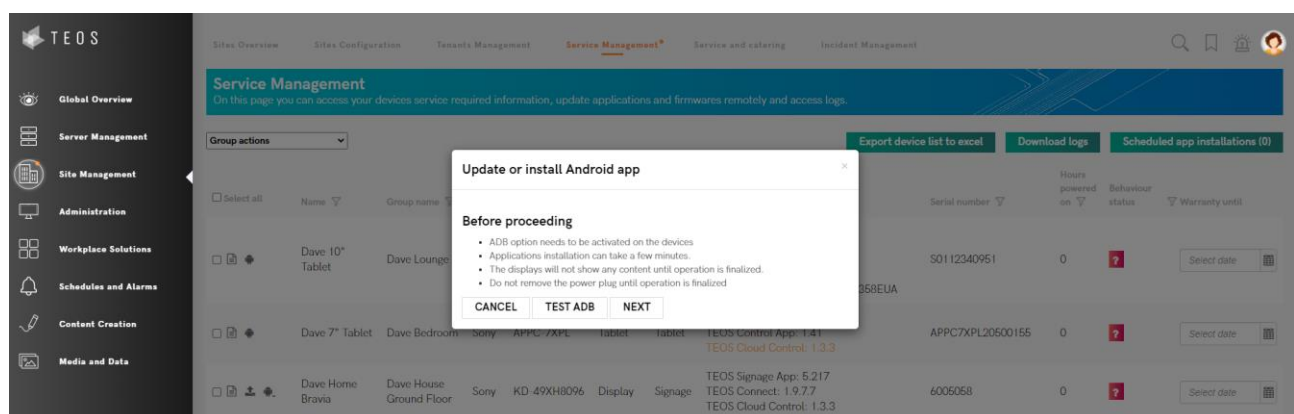

To allow this ADB debugging you have 2 options:

1. Most simple one is by using the real device remote
2. The second one if you IP Control is ON is by using the enter button + right arrow + enter button

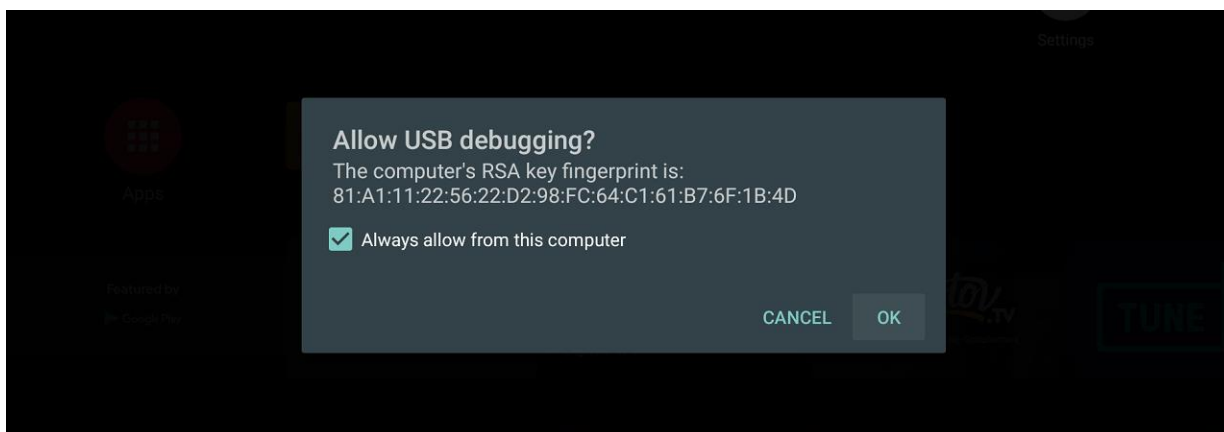

As soon as the it is allowed, you will be able to see the interface of the device into your virtual remote or in service management, you can test again adb and see it "online".

If the operation failed, a deep reboot (pressing the reboot button of the virtual remote) and opening again the virtual remote will request again for adb connection.

4.2 When using TEOS on Cloud (from version 3.0)

Go to your Manage for **TEOS CLOUD Interface** > Administration > Device management. We will add in this case manually a device to the cloud, for that press on the drop down button on "Connecting cloud-controlled devices" to see the password **automatically regenerated every 1 hour** to insert in the device

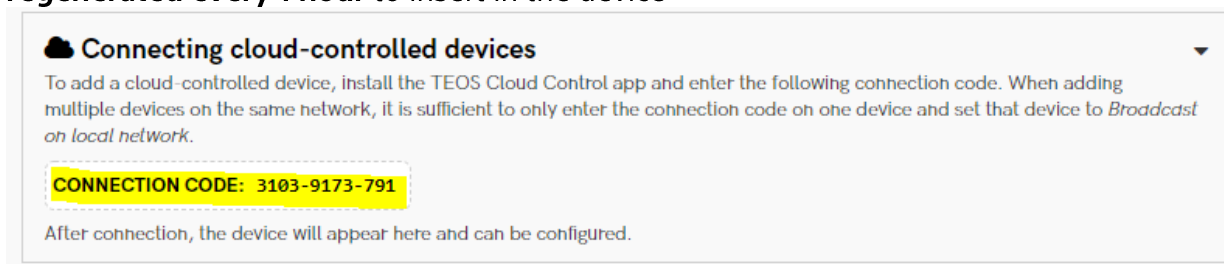

Now from the device, make sure it is connected to the internet. Open the app Cloud Control for TEOS (version 1.4.2 minimum) and insert the password, press connect.

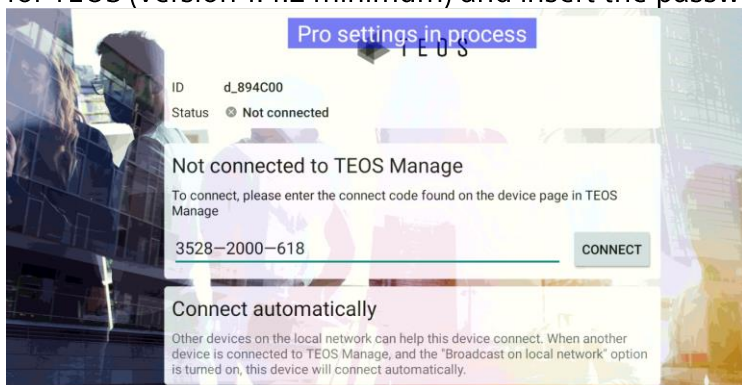

The device will then connect automatically to your cloud account without any additional action.

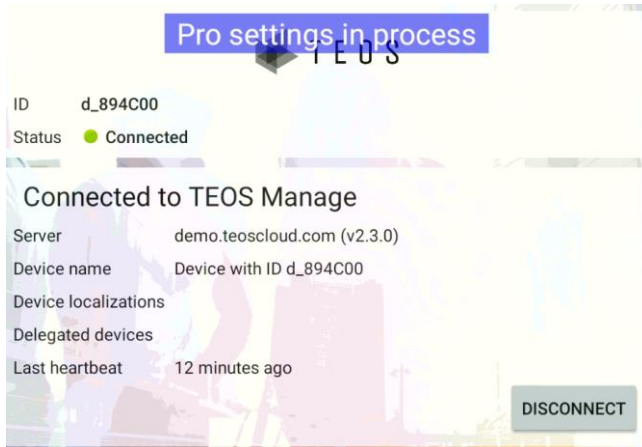

The ID shown in the device will appear in the AV device list after a refresh of the page and will be shown and this end of it.

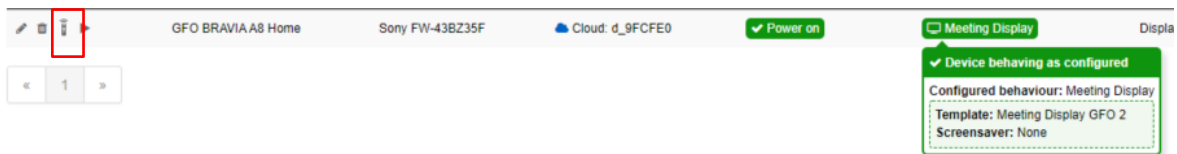

You can then setup it by clicking on the edit button:

- i) Insert the room or device name
- j) Select "display" as device type
- k) Select Sony as device brand
- l) Model will be automatically field
- m) Select the license type
- n) Add the device into a device group (create before a group in site configuration)
- o) Press **save**

If you need further support, please contact Sony PrimeSupport or contact us using our website <http://pro.sony> partner portal

SONY



For more information
visit **pro.sony/TEOS**

© 2021 Sony Corporation